

POWER MILLING CHUCK (QUICK CHANGE)

SCHNELLWECHSEL GEGENSTÜCK FÜR FRÄSERSPANNFUTTER
 CHANGEMENT RAPIDE ETUI AVEC PORTE-FRAISE ET CLEF
 CAMBIO RAPIDO CASSETTA COMPLETA DI MANDRINO, CHIAVE E PINZE
 CAMBIO RAPIDO ESTUCHE CON PORTAPINZAS, PINZAS Y LLAVE



TAPER	Q.C MILLING HOLDER SET MODEL No.	EDP No.	Q.C MASTER HOLDER	Q.C MILLING CHUCK	END MILL COLLETS	Q.C FACE MILL ARBOR	Q.C DRILL CHUCK BAR	DRILL CHUCK ARBOR	Q.C TAPER SLEEVE	SPANNER
NT40	SMH40-T35-32A	P2773307	MH40-T35	QT35-32	K32-(6-25)(7pcs)	QT35-4R	-	K32-J6	-	MH40 SP
	SMH40-T35-32B	P2773308	MH40-T35	QT35-32	K32-(6-25)(7pcs)	QT35-4R	QT35-J6	-	QT35-MT2, 3, 4	MH40 SP
NT50	SMH50-T45-32A	P2773309	MH50-T45	QT45-32	K32-(6-25)(7pcs)	QT45-5R	-	K32-J6	-	MH50 SP
	SMH50-T45-32B	P2773310	MH50-T45	QT45-32	K32-(6-25)(7pcs)	QT45-5R	QT45-J6	-	QT45-MT2, 3, 4	MH50 SP
	SMH50-T45-42A	P2773311	MH50-T45	QT45-42	K42-(6-32)(8pcs)	QT45-5R	-	K42-J6	-	MH50 SP
	SMH50-T45-42B	P2773312	MH50-T45	QT45-42	K42-(6-32)(8pcs)	QT45-5R	QT45-J6	-	QT45-MT2, 3, 4	MH50 SP

YG-1 TOOLING SYSTEM

BORING SYSTEM

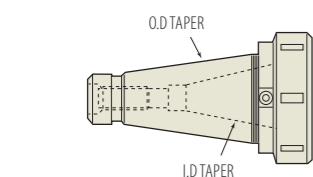

◆ Q.C MASTER HOLDER

MODEL No.	EDP No.	O.D TAPER	I.D TAPER	DRAW THREADS
MH40-T35	P2773313	NT40	NT35	U5/8-11(M16-2)
MH50-T45	P2773314	NT50	NT45	U1-8 (M24-3)

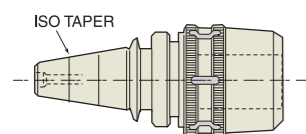

◆ Q.C MILLING CHUCK

Q.C MASTER HOLDER	MODEL No.	EDP No.
MH40	QT35-C32	P2773315
MH50	QT45-C32	P2773316
MH50	QT45-C42	P2773317

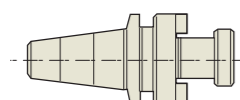

◆ Q.C FACE MILL ARBOR

Q.C MASTER HOLDER	MODEL No.	EDP No.
MH40	QT35-3R	P2773318
	QT35-4R	P2773319
	QT35-5R	P2773320
MH50	QT45-3R	P2773321
	QT45-4R	P2773322
	QT45-5R	P2773323
	QT45-6R	P2773324

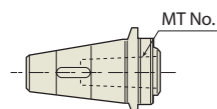

◆ Q.C TAPER SLEEVE

Q.C MASTER HOLDER	MODEL No.	EDP No.
MH40	QT35-MT1	P2773325
	QT35-MT2	P2773326
	QT35-MT3	P2773327
MH50	QT45-MT1	P2773328
	QT45-MT2	P2773329
	QT45-MT3	P2773330
	QT45-MT4	P2773331

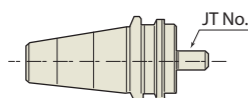

◆ Q.C DRILL CHUCK ARBOR

Q.C MASTER HOLDER	MODEL No.	EDP No.	DRILL (Ø)
MH40	QT35-J6	P2773332	1-13mm
MH50	QT45-J6	P2773333	1-13mm



- TECHNICAL INFORMATION (SMALL BORE)
- BASIC HOLDER
- FINE BORING HEAD & INSERT HOLDER
- ROUGH BORING HEAD & CARTRIDGE
- EXTENSION BAR
- REDUCTION BAR
- TYPICAL CONFIGURATION OF FINE BORING BAR
- TYPICAL CONFIGURATION OF ROUGH BORING BAR
- TECHNICAL INFORMATION (BIG BORE)
- BASIC HOLDER (BIG BORE)
- FINE BORING HEAD (BIG BORE)
- PLATE & CARTRIDGE (BIG BORE)
- FINE BORING BAR (BIG BORE)
- ROUGH BORING BAR (BIG BORE)
- MICRO BORING BAR
- SQUARE BORING BAR

FINE & ROUGH BORING BAR (SMALL BORE)

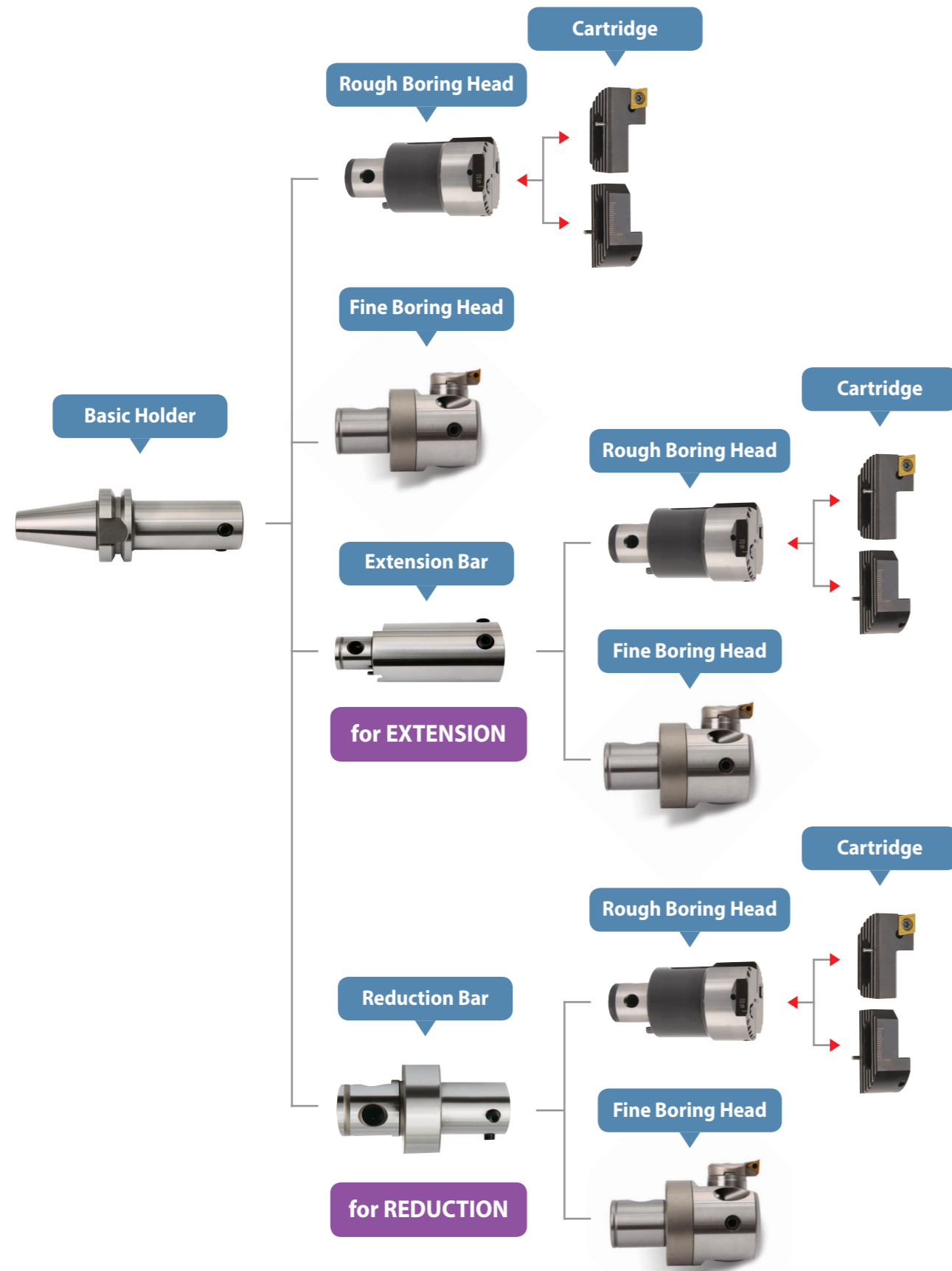

Fine Boring Range : 20mm~154mm



FEATURE

- Easy assembly and wide expandability
- Precise boring range adjustment by adjustment Dial with 1/100mm unit
- Ease to adjust length by employing modular system to use extension bar with various size
- Double rigid fixing of extension bar with
 - Side locking
 - Fixing pin inside
- Design to use insert conforming to ISO standard
- Basic Holder, Extension Bar and Reduction Bar interchangeable between Fine Boring Bar and Rough Boring Bar

Rough Boring Range : 25mm~156mm



FEATURE

- Easy to replace head
- Extension Bar : Adjusting length according to machining conditions
- Reduction Bar : Adjusting boring range according to machining conditions
- Precision of extension, reduction, and repeatability of assembling and disassembling of Boring Head
- Using insert conforming to ISO standard
- Basic Holder, Extension Bar and Reduction Bar interchangeable between Fine Boring Bar and Rough Boring Bar

FINE & ROUGH BORING BAR (SMALL BORE)

SK (DIN 69871)

CBT (BT DUAL CONTACT)

BT (JIS B6339/MAS 403)

HSK (DIN 69893/ISO 12164)

STRAIGHT

ISO, NT, MTA/MTB, GOST

TOOL HOLDER SET

BORING SYSTEM

ACCESSORY & PARTS

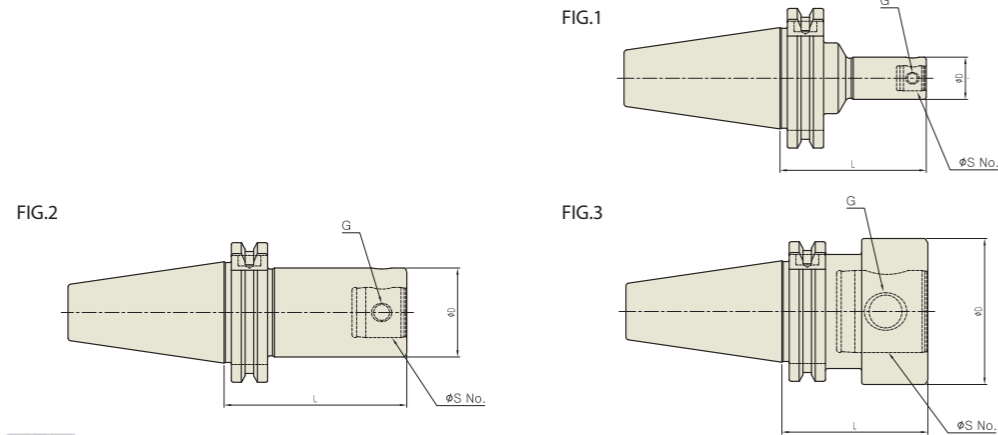

SK (DIN 69871/ISO 7388-1)

Unit : mm

TAPER No.	MODEL No.	EDP No.	S No.	D	L	G	FIG.	WEIGHT (Kg)
40	SK40-S11-72	P2900001	11	18.5	72	M5x0.8	1	-
	SK40-S14-42.5	P2900002	14	23.5	42.5	M5x0.8	2	-
	SK40-S14-82.5	P2900003	14	23.5	82.5	M5x0.8	2	-
	SK40-S18-44	P2900004	18	31	44	M8x1.0	2	-
	SK40-S18-94	P2900005	18	31	94	M8x1.0	2	-
	SK40-S22-43	P2900006	22	39	43	M8x1.0	2	-
	SK40-S22-88	P2900007	22	39	88	M8x1.0	2	-
	SK40-S28-48	P2900008	28	50	48	M10x1.0	2	-
	SK40-S36-64	P2900009	36	64	64	M16x1.5	3	-
	SK40-S46-95	P2900010	46	90	95	M16x1.5	3	-
50	SK50-S11-102	P2900011	11	18.5	102	M5x0.8	1	-
	SK50-S14-52.5	P2900012	14	23.5	52.5	M5x0.8	2	-
	SK50-S14-112.5	P2900013	14	23.5	112.5	M5x0.8	2	-
	SK50-S18-54	P2900014	18	31	54	M8x1.0	2	-
	SK50-S18-124	P2900015	18	31	124	M8x1.0	2	-
	SK50-S22-58	P2900016	22	39	58	M8x1.0	2	-
	SK50-S22-178	P2900017	22	39	178	M8x1.0	2	-
	SK50-S28-63	P2900018	28	50	63	M10x1.0	2	-
	SK50-S28-105	P2900019	28	50	105	M10x1.0	2	-
	SK50-S28-183	P2900020	28	50	183	M10x1.0	2	-
	SK50-S28-228	P2900021	28	50	228	M10x1.0	2	-
	SK50-S36-94	P2900022	36	64	94	M16x1.5	2	-
	SK50-S36-169	P2900023	36	64	169	M16x1.5	2	-
	SK50-S36-229	P2900024	36	64	229	M16x1.5	2	-
	SK50-S46-93	P2900025	46	90	93	M16x1.5	3	-
	SK50-S46-243	P2900026	46	90	243	M16x1.5	3	-

- ▶ The Basic Holder interchangeable between Fine Boring and Rough Boring bar.
- ▶ The Basic Holder, Boring Head & Insert Holder must be ordered separately.

FINE & ROUGH BORING BAR (SMALL BORE)

SK (DIN 69871)

CBT (BT DUAL CONTACT)

BT (JIS B6339/MAS 403)

HSK (DIN 69893/ISO 12164)

STRAIGHT

ISO, NT, MTA/MTB, GOST

TOOL HOLDER SET

BORING SYSTEM

ACCESSORY & PARTS

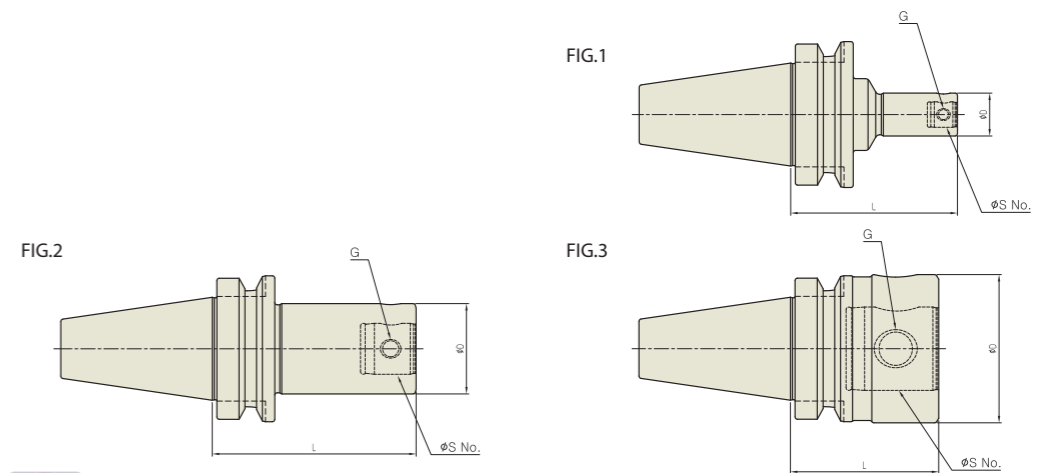

BT (JIS B6339/MAS403/ISO 7388-2)

Unit : mm

TAPER No.	MODEL No.	EDP No.	S No.	D	L	G	FIG.	WEIGHT (Kg)
30	BT30-S11-72	P2901001	11	18.5	72	M5x0.8	1	-
	BT30-S14-37.5	P2901002	14	23.5	37.5	M5x0.8	2	-
	BT30-S14-82.5	P2901003	14	23.5	82.5	M5x0.8	2	-
	BT30-S18-39	P2901004	18	31	39	M8x1.0	2	-
	BT30-S18-79	P2901005	18	31	79	M8x1.0	2	-
	BT30-S22-38	P2901006	22	39	38	M8x1.0	2	-
	BT30-S22-73	P2901007	22	39	73	M8x1.0	2	-
	BT30-S28-63	P2901008	28	50	63	M10x1.0	3	-
	BT40-S11-72	P2901009	11	18.5	72	M5x0.8	2	-
	BT40-S14-42.5	P2901010	14	23.5	42.5	M5x0.8	2	-
40	BT40-S14-82.5	P2901011	14	23.5	82.5	M5x0.8	2	-
	BT40-S18-44	P2901012	18	31	44	M8x1.0	2	-
	BT40-S18-94	P2901013	18	31	94	M8x1.0	2	-
	BT40-S22-43	P2901014	22	39	43	M8x1.0	2	-
	BT40-S22-88	P2901015	22	39	88	M8x1.0	2	-
	BT40-S28-48	P2901016	28	50	48	M10x1.0	2	-
	BT40-S28-79	P2901017	28	50	79	M10x1.0	2	-
	BT40-S36-64	P2901018	36	64	64	M16x1.5	3	-
	BT40-S46-90	P2901019	46	90	90	M16x1.5	3	-

- ▶ The Basic Holder interchangeable between Fine Boring and Rough Boring bar.
- ▶ The Basic Holder, Boring Head & Insert Holder must be ordered separately.

▶ NEXT PAGE

FINE & ROUGH BORING BAR (SMALL BORE)

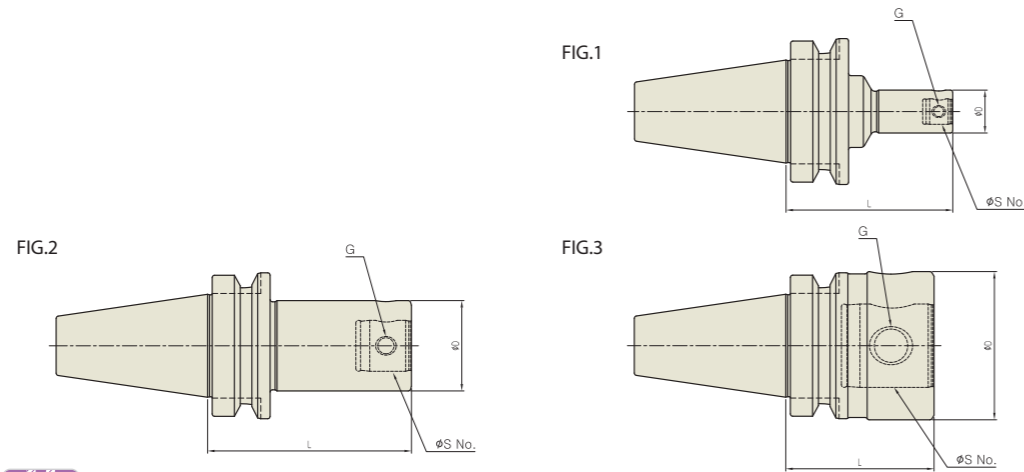

BT (JIS B6339/MAS403/ISO 7388-2)

Unit : mm

TAPER No.	MODEL No.	EDP No.	S No.	D	L	G	FIG.	WEIGHT (Kg)
50	BT50-S11-102	P2901020	11	18.5	102	M5x0.8	1	-
	BT50-S14-52.5	P2901021	14	23.5	52.5	M5x0.8	2	-
	BT50-S14-112.5	P2901022	14	23.5	112.5	M5x0.8	2	-
	BT50-S18-54	P2901023	18	31	54	M8x1.0	2	-
	BT50-S18-124	P2901024	18	31	124	M8x1.0	2	-
	BT50-S22-58	P2901025	22	39	58	M8x1.0	2	-
	BT50-S22-118	P2901026	22	39	118	M8x1.0	2	-
	BT50-S22-178	P2901027	22	39	178	M8x1.0	2	-
	BT50-S28-63	P2901028	28	50	63	M10x1.0	2	-
	BT50-S28-108	P2901029	28	50	108	M10x1.0	2	-
	BT50-S28-183	P2901030	28	50	183	M10x1.0	2	-
	BT50-S28-228	P2901031	28	50	228	M10x1.0	2	-
	BT50-S36-94	P2901032	36	64	94	M16x1.5	2	-
	BT50-S36-169	P2901033	36	64	169	M16x1.5	2	-
	BT50-S36-229	P2901034	36	64	229	M16x1.5	2	-
	BT50-S46-93	P2901035	46	90	93	M16x1.5	2	-
	BT50-S46-243	P2901036	46	90	243	M16x1.5	2	-

- ▶ The Basic Holder interchangeable between Fine Boring and Rough Boring bar.
- ▶ The Basic Holder, Boring Head & Insert Holder must be ordered separately.

FINE & ROUGH BORING BAR (SMALL BORE)

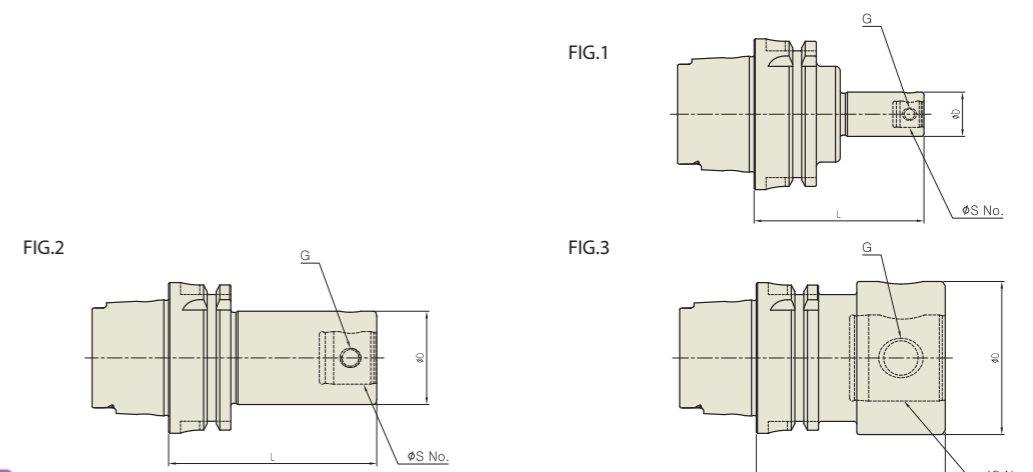

HSK-A (DIN 69893/ISO 12164)

Unit : mm

TAPER No.	MODEL No.	EDP No.	S No.	D	L	G	FIG.	WEIGHT (Kg)
40A	HSK40A-S11-72.5	P2902001	11	18.5	72.5	M5x0.8	2	-
	HSK40A-S14-39.5	P2902002	14	23.5	39.5	M5x0.8	2	-
	HSK40A-S14-84.5	P2902003	14	23.5	84.5	M5x0.8	2	-
	HSK40A-S18-45	P2902004	18	31	45	M8x1.0	2	-
	HSK40A-S18-80	P2902005	18	31	80	M8x1.0	2	-
	HSK40A-S22-53	P2902006	22	39	53	M8x1.0	3	-
	HSK40A-S22-73	P2902007	22	39	73	M8x1.0	3	-
50A	HSK50A-S11-72.5	P2902008	11	18.5	72.5	M5x0.8	2	-
	HSK50A-S14-84.5	P2902009	14	23.5	84.5	M5x0.8	2	-
	HSK50A-S18-80	P2902010	18	31	80	M8x1.0	2	-
	HSK50A-S22-73	P2902011	22	39	73	M8x1.0	3	-
	HSK50A-S28-83	P2902012	28	50	83	M10x1.0	3	-
63A	HSK63A-S11-77.5	P2902013	11	18.5	77.5	M5x0.8	2	-
	HSK63A-S14-89.5	P2902014	14	23.5	89.5	M5x0.8	2	-
	HSK63A-S18-100	P2902015	18	31	100	M8x1.0	2	-
	HSK63A-S22-93	P2902016	22	39	93	M8x1.0	2	-
	HSK63A-S28-83	P2902017	28	50	83	M10x1.0	2	-
	HSK63A-S36-79	P2902018	36	64	79	M16x1.5	3	-
	HSK63A-S46-100	P2902019	46	90	100	M16x1.5	3	-
100A	HSK100A-S11-102.5	P2902020	11	18.5	102.5	M5x0.8	1	-
	HSK100A-S14-114.5	P2902021	14	23.5	114.5	M5x0.8	1	-
	HSK100A-S18-125	P2902022	18	31	125	M8x1.0	1	-
	HSK100A-S22-118	P2902023	22	39	118	M8x1.0	2	-
	HSK100A-S22-178	P2902024	22	39	178	M8x1.0	2	-
	HSK100A-S28-108	P2902025	28	50	108	M10x1.0	2	-
	HSK100A-S28-183	P2902026	28	50	183	M10x1.0	2	-
	HSK100A-S28-228	P2902027	28	50	228	M10x1.0	2	-
	HSK100A-S36-94	P2902028	36	64	94	M16x1.5	2	-
	HSK100A-S36-169	P2902029	36	64	169	M16x1.5	2	-
	HSK100A-S36-229	P2902030	36	64	229	M16x1.5	2	-
	HSK100A-S46-123	P2902031	46	90	123	M16x1.5	2	-
	HSK100A-S46-273	P2902032	46	90	273	M16x1.5	2	-

- ▶ The Basic Holder interchangeable between Fine Boring and Rough Boring bar.
- ▶ The Basic Holder, Boring Head & Insert Holder must be ordered separately.

SK (DIN 69871)

CBT (BT DUAL CONTACT)

BT (JIS B6339/MAS 403)

HSK (DIN 69893/ISO 12164)

STRAIGHT

ISO, NT, MTA/MTB, GOST

TOOL HOLDER SET

BORING SYSTEM

ACCESSORY & PARTS

YIG FINE BORING HEAD & INSERT HOLDER

PART

FINE BORING BAR (SMALL BORE)

FEINBOHRHALTER
ALÉSAGE PROFOND
BARRE DI ALESATURA FINE
BARRA DE MANDRINADO FINO

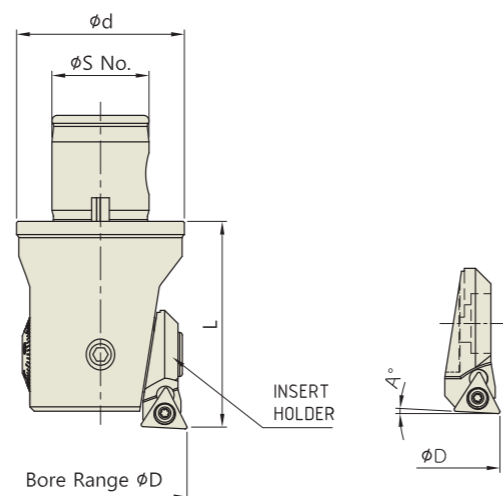

◆ FINE BORING HEAD

Unit : mm

HEAD	EDP No.	INSERT HOLDER	BORE RANGE (ØD)	S No.	d	L
S11-FBH20-24	P2903001	FBH20-1	Ø20~24	11	18.5	32.5
S14-FBH24-31	P2903002	FBH24-1	Ø23.9~31.1	14	23.5	35
S18-FBH31-40	P2903003	FBH31-1	Ø30.9~40.1	18	30	40
S22-FBH40-51	P2903004	FBH40-1	Ø39.9~51.1	22	38	47
S28-FBH51-67	P2903005	FBH51-1	Ø50.9~67.1	28	49	57
S36-FBH67-125	P2903006	FBH6787-1	Ø66.9~87.1	36	64	71
		FBH6787-2	Ø84.9~105.1			
		FBH6787-3	Ø104.9~125.1			
S46-FBH87-154	P2903007	FBH6787-1	Ø86.9~116.1	46	90	87
		FBH6787-2	Ø104.9~134.1			
		FBH6787-3	Ø124.9~154.1			

◆ FINE BORING INSERT HODER

Unit : mm

Model No.	EDP No.	BORE RANGE (ØD)	A°	INSERT	INSERT SCREW	TORX WRENCH
FBH20-1	P2904001	20~24	0	TPGH0802□□	FTNA0204	T06
FBH24-1	P2904002	23.9~31.1	0			
FBH31-1	P2904003	30.9~40.1	0			
FBH40-1	P2904004	39.9~51.1	3			
FBH51-1	P2904005	50.9~67.1	3			
FBH6787-1	P2904006	66.9~87.1	3	TPGH1103□□	FTNA0307	T09
		86.9~116.1				
FBH6787-2	P2904007	84.9~105.1	3			
		104.9~134.1				
FBH6787-3	P2904008	104.9~125.1	3			
		124.9~154.1				

- ▶ The Insert Holder Clamp Screw is supplied with Boring Head.
- ▶ The Insert Screw is supplied with Insert Holder.
- ▶ The Torx Wrench should be ordered. Please contact us to purchase this wrench.
- ▶ The Boring Head & Insert Holder must be ordered separately.
- ▶ CC type inserts (CC06, CC09) are available.

YIG ROUGH BORING HEAD & CARTRIDGE

PART

ROUGH BORING BAR (SMALL BORE)

DOPPELBOHRHALTER
BARRE D'ALÉSAGE JUMEAUX
BARRE DI ALESATURA GEMELLO
BARRA DE MANDRINAR MELLIZO

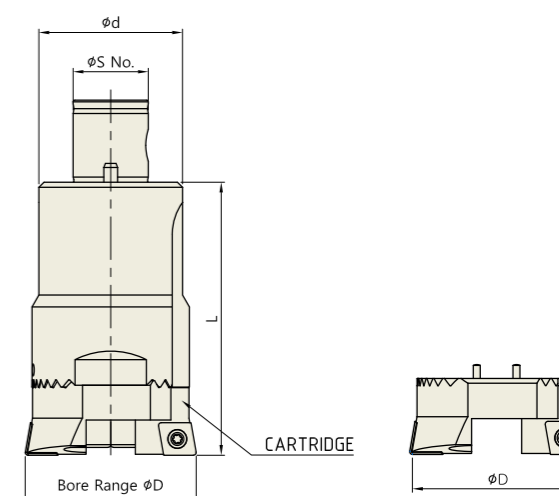

◆ ROUGH BORING HEAD

Unit : mm

HEAD	EDP No.	CARTRIDGE	BORE RANGE (ØD)	S No.	d	L
S11-TBH25-34	P2905001	TBH25-34	Ø25~34	11	22	50
S18-TBH34-51	P2905002	TBH34-43N	Ø34~43	18	31	60
		TBH42-51N	Ø42~51			
S22-TBH50-77	P2905003	TBH50-64N	Ø50~64	22	42	80
		TBH63-77N	Ø63~77			
S36-TBH76-116	P2905004	TBH76-97N	Ø76~97	36	65	110
		TBH95-116N	Ø95~116			
S46-TBH115-156	P2905005	TBH115-136N	Ø115~136	46	90	105
		TBH135-156N	Ø135~156			

◆ ROUGH BORING CARTRIDGE

Unit : mm

Model No.	EDP No.	BORE RANGE (ØD)	INSERT	INSERT SCREW	TORX WRENCH
TBH25-34	P2906001	25~34	CCMT0602□□	FTKA02565	T07
TBH34-43N	P2906002	34~43	CCMT0602□□	FTKA02565	T07
TBH42-51N	P2906006	42~51			
TBH50-64N	P2906003	50~64	CCMT09T3□□	FTNA0408	T15
TBH63-77N	P2906007	63~77			
TBH76-97N	P2906004	76~97	CCMT1204□□	FTNA0513	T20
TBH95-116N	P2906008	95-116			
TBH115-136N	P2906005	115~136			
TBH135-156N	P2906009	135~156	CCMT1204□□	FTNA0513	T20

- ▶ The Cartridge Clamp Screw is supplied with Boring Head.
- ▶ The Insert Screw is supplied with Cartridge.
- ▶ The Torx Wrench should be ordered. Please contact us to purchase this wrench.
- ▶ The Boring Head & Insert Holder must be ordered separately.

YG EXTENSION BAR

PART

FINE & ROUGH BORING BAR (SMALL BORE)

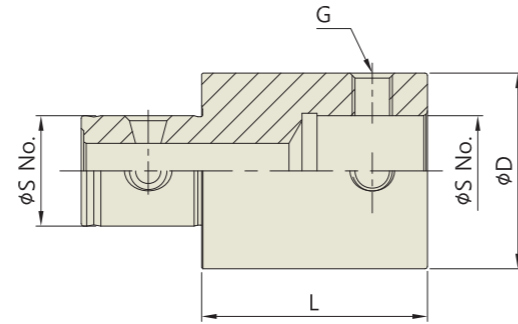

YG REDUCTION BAR

PART

FINE & ROUGH BORING BAR (SMALL BORE)

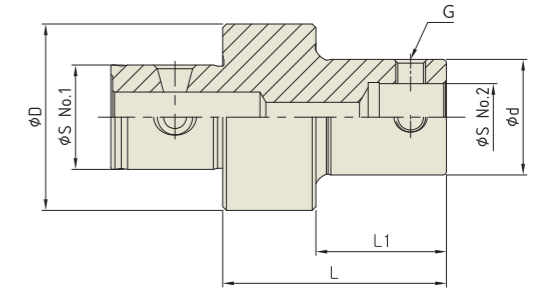

Unit : mm

MODEL No.	EDP No.	S No.	D	L	G	WEIGHT (Kg)
E-S11-30	P2907001	11	19	30	M5x0.8	-
E-S14-30	P2907002	14	24	30	M5x0.8	-
E-S18-30	P2907003	18	31	30	M8x1.0	-
E-S22-45	P2907004	22	39	45	M8x1.0	-
E-S28-60	P2907005	28	50	60	M10x1.0	-
E-S28-90	P2907006	28	50	90	M10x1.0	-
E-S36-60	P2907007	36	64	60	M16x1.5	-
E-S36-100	P2907008	36	64	100	M16x1.5	-
E-S46-105	P2907009	46	90	105	M16x1.5	-

► Extends projection length by insertion between Basic Holder & Boring Head.

Unit : mm

MODEL No.	EDP No.	S No.1	S No.2	D	d	L	L1	G	WEIGHT (Kg)
R-S14-S11-30	P2908001	14	11	24	19	30	20	M5x0.8	-
R-S18-S11-30	P2908002	18	11	31	19	30	20	M5x0.8	-
R-S18-S14-30	P2908003	18	14	31	24	30	20	M5x0.8	-
R-S22-S11-45	P2908004	22	11	39	19	45	25	M5x0.8	-
R-S22-S14-45	P2908005	22	14	39	24	45	25	M5x0.8	-
R-S22-S18-45	P2908006	22	18	39	31	45	25	M8x1.0	-
R-S28-S11-60	P2908007	28	11	50	19	60	35	M5x0.8	-
R-S28-S14-60	P2908008	28	14	50	24	60	35	M5x0.8	-
R-S28-S18-60	P2908009	28	18	50	31	60	35	M8x1.0	-
R-S28-S22-60	P2908010	28	22	50	39	60	35	M8x1.0	-
R-S36-S11-60	P2908011	36	11	64	19	60	35	M5x0.8	-
R-S36-S14-60	P2908012	36	14	64	24	60	35	M5x0.8	-
R-S36-S18-60	P2908013	36	18	64	31	60	35	M8x1.0	-
R-S36-S22-60	P2908014	36	22	64	39	60	35	M8x1.0	-
R-S36-S28-60	P2908015	36	28	64	50	60	35	M10x1.0	-
R-S46-S11-105	P2908016	46	11	90	19	105	75	M5x0.8	-
R-S46-S14-105	P2908017	46	14	90	24	105	75	M5x0.8	-
R-S46-S18-105	P2908018	46	18	90	31	105	75	M8x1.0	-
R-S46-S22-105	P2908019	46	22	90	39	105	75	M8x1.0	-
R-S46-S28-105	P2908020	46	28	90	50	105	75	M10x1.0	-
R-S46-S36-105	P2908021	46	36	90	64	105	75	M16x1.5	-

► Reduces the connection sizes to use smaller Boring Head.

SK (DIN 69871)

CBT (BT DUAL CONTACT)

BT (JIS B6339/ MAS 403)

HSK (DIN 69893/ ISO 12164)

STRAIGHT

ISO, NT, MTA/MTB, GOST

TOOL HOLDER SET

BORING SYSTEM

ACCESSORY & PARTS



TYPICAL CONFIGURATION OF FINE BORING BAR

FBH

FINE BORING BAR (SMALL BORE)

FEINBOHRHALTER
 BARRE D'ALÉSAGE FIN
 BARRE DI ALESATURA FINE
 BARRA DE MANDRINADO FINO

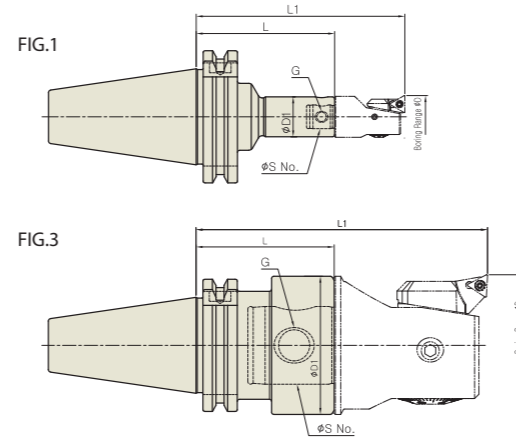

SK (DIN 69871/ISO 7388-1)

Unit : mm

TAPER No.	BASIC HOLDER	FINE BORING HEAD	INSERT HOLDER	BORE RANGE (ØD)	S No.	D1	L	L1	G	FIG.	WEIGHT (Kg)
40	SK40-S11-72	S11-FBH20-24	FBH20-1	Ø20 ~ Ø24	11	18.5	72	104.5	M5x0.8	1	-
	SK40-S14-42.5	S14-FBH24-31	FBH24-1	Ø23.9 ~ Ø31.1	14	23.5	42.5	77.5	M5x0.8	2	-
	SK40-S14-82.5	S14-FBH24-31	FBH24-1	Ø23.9 ~ Ø31.1	14	23.5	82.5	117.5	M5x0.8	2	-
	SK40-S18-44	S18-FBH31-40	FBH31-1	Ø30.9 ~ Ø40.1	18	31	44	84	M8x1.0	2	-
	SK40-S18-94	S18-FBH31-40	FBH31-1	Ø30.9 ~ Ø40.1	18	31	94	134	M8x1.0	2	-
	SK40-S22-43	S22-FBH40-51	FBH40-1	Ø39.9 ~ Ø51.1	22	39	43	90	M8x1.0	2	-
	SK40-S22-88	S22-FBH40-51	FBH40-1	Ø39.9 ~ Ø51.1	22	39	88	135	M8x1.0	2	-
	SK40-S28-48	S28-FBH51-67	FBH51-1	Ø50.9 ~ Ø67.1	28	50	48	105	M10x1.0	2	-
	SK40-S36-64	S36-FBH67-125	FBH6787-1	Ø66.9 ~ Ø87.1	36	64	64	135	M16x1.5	3	-
			FBH6787-2	Ø84.9 ~ Ø105.1							-
			FBH6787-3	Ø104.9 ~ Ø125.1							-
	SK40-S46-95	S46-FBH87-154	FBH6787-1	Ø86.9 ~ Ø116.1	46	90	95	177	M16x1.5	3	-
			FBH6787-2	Ø104.9 ~ Ø134.1							-
			FBH6787-3	Ø124.9 ~ Ø154.1							-

- ▶ This is for help selecting Fine Boring Head & Insert Holder.
- ▶ The Insert Holder Clamp Screw is supplied with Boring Head.
- ▶ The Insert Screw is supplied with Insert Holder.
- ▶ The Torx Wrench should be ordered. Please contact us to purchase this wrench.
- ▶ The Basic Holder, Boring Head & Insert Holder must be ordered separately.
- ▶ The L, L1 dimensions in the table are the reference values when Boring Head and Insert Holder are mounted.

▶ NEXT PAGE



TYPICAL CONFIGURATION OF FINE BORING BAR

FBH

FINE BORING BAR (SMALL BORE)

FEINBOHRHALTER
 BARRE D'ALÉSAGE FIN
 BARRE DI ALESATURA FINE
 BARRA DE MANDRINADO FINO

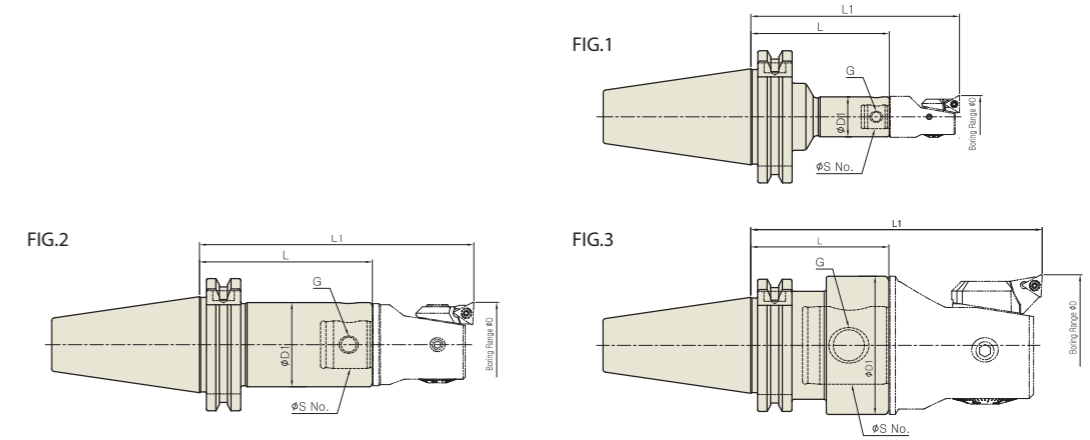

SK (DIN 69871/ISO 7388-1)

Unit : mm

TAPER No.	BASIC HOLDER	FINE BORING HEAD	INSERT HOLDER	BORE RANGE (ØD)	S No.	D1	L	L1	G	FIG.	WEIGHT (Kg)
50	SK50-S11-102	S11-FBH20-24	FBH20-1	Ø20 ~ Ø24	11	18.5	102	134.5	M5x0.8	1	-
	SK50-S14-52.5	S14-FBH24-31	FBH24-1	Ø23.9 ~ Ø31.1	14	23.5	52.5	87.5	M5x0.8	2	-
	SK50-S14-112.5	S14-FBH24-31	FBH24-1	Ø23.9 ~ Ø31.1	14	23.5	112.5	147.5	M5x0.8	2	-
	SK50-S18-54	S18-FBH31-40	FBH31-1	Ø30.9 ~ Ø40.1	18	31	54	94	M8x1.0	2	-
	SK50-S18-124	S18-FBH31-40	FBH31-1	Ø30.9 ~ Ø40.1	18	31	124	164	M8x1.0	2	-
	SK50-S22-58	S22-FBH40-51	FBH40-1	Ø39.9 ~ Ø51.1	22	39	58	105	M8x1.0	2	-
	SK50-S22-178	S22-FBH40-51	FBH40-1	Ø39.9 ~ Ø51.1	22	39	178	225	M8x1.0	2	-
	SK50-S28-63	S28-FBH51-67	FBH51-1	Ø50.9 ~ Ø67.1	28	50	63	120	M10x1.0	2	-
	SK50-S28-105	S28-FBH51-67	FBH51-1	Ø50.9 ~ Ø67.1	28	50	105	162	M10x1.0	2	-
	SK50-S28-183	S28-FBH51-67	FBH51-1	Ø50.9 ~ Ø67.1	28	50	183	240	M10x1.0	2	-
	SK50-S28-228	S28-FBH51-67	FBH51-1	Ø50.9 ~ Ø67.1	28	50	228	285	M10x1.0	2	-
	SK50-S36-94	S36-FBH67-125	FBH6787-1	Ø66.9 ~ Ø87.1	36	64	94	165	M16x1.5	2	-
			FBH6787-2	Ø84.9 ~ Ø105.1							-
			FBH6787-3	Ø104.9 ~ Ø125.1							-
SK50-S36-169	S36-FBH67-125	FBH6787-1	Ø66.9 ~ Ø87.1	36	64	169	240	M16x1.5	2	-	
		FBH6787-2	Ø84.9 ~ Ø105.1							-	
		FBH6787-3	Ø104.9 ~ Ø125.1							-	
SK50-S36-229	S36-FBH67-125	FBH6787-1	Ø66.9 ~ Ø87.1	36	64	229	300	M16x1.5	2	-	
		FBH6787-2	Ø84.9 ~ Ø105.1							-	
		FBH6787-3	Ø104.9 ~ Ø125.1							-	
SK50-S46-93	S46-FBH87-154	FBH6787-1	Ø86.9 ~ Ø116.1	46	90	93	180	M16x1.5	3	-	
		FBH6787-2	Ø104.9 ~ Ø134.1							-	
		FBH6787-3	Ø124.9 ~ Ø154.1							-	
SK50-S46-243	S46-FBH87-154	FBH6787-1	Ø86.9 ~ Ø116.1	46	90	243	330	M16x1.5	3	-	
		FBH6787-2	Ø104.9 ~ Ø134.1							-	
		FBH6787-3	Ø124.9 ~ Ø154.1							-	

- ▶ This is for help selecting Fine Boring Head & Insert Holder.
- ▶ The Insert Holder Clamp Screw is supplied with Boring Head.
- ▶ The Insert Screw is supplied with Insert Holder.
- ▶ The Torx Wrench should be ordered. Please contact us to purchase this wrench.
- ▶ The Basic Holder, Boring Head & Insert Holder must be ordered separately.
- ▶ The L, L1 dimensions in the table are the reference values when Boring Head and Insert Holder are mounted.

YIG TYPICAL CONFIGURATION OF FINE BORING BAR

FBH

FINE BORING BAR (SMALL BORE)

FEINBOHRHALTER
 BARRE D'ALÉSAGE FIN
 BARRE DI ALESATURA FINE
 BARRA DE MANDRINADO FINO

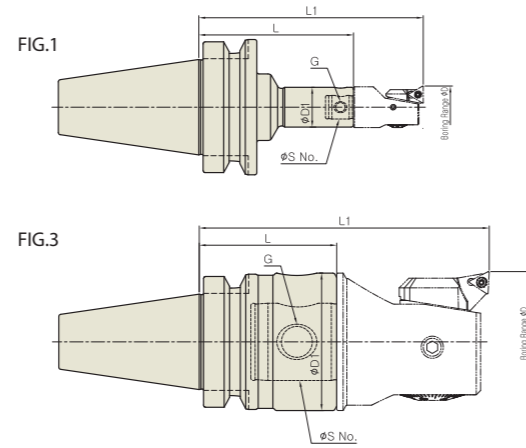

BT (JIS B6339/MAS 403/ISO 7388-2)

Unit : mm

TAPER No.	BASIC HOLDER	FINE BORING HEAD	INSERT HOLDER	BORE RANGE (ØD)	S No.	D1	L	L1	G	FIG.	WEIGHT (Kg)
30	BT30-S11-72	S11-FBH20-24	FBH20-1	Ø20 ~ Ø24	11	18.5	72	104.5	M5x0.8	1	-
	BT30-S14-37.5	S14-FBH24-31	FBH24-1	Ø23.9 ~ Ø31.1	14	23.5	37.5	72.5	M5x0.8	2	-
	BT30-S14-82.5	S14-FBH24-31	FBH24-1	Ø23.9 ~ Ø31.1	14	23.5	82.5	117.5	M5x0.8	2	-
	BT30-S18-39	S18-FBH31-40	FBH31-1	Ø30.9 ~ Ø40.1	18	31	39	79	M8x1.0	2	-
	BT30-S18-79	S18-FBH31-40	FBH31-1	Ø30.9 ~ Ø40.1	18	31	79	119	M8x1.0	2	-
	BT30-S22-38	S22-FBH40-51	FBH40-1	Ø39.9 ~ Ø51.1	22	39	38	85	M8x1.0	2	-
	BT30-S22-73	S22-FBH40-51	FBH40-1	Ø39.9 ~ Ø51.1	22	39	73	120	M8x1.0	2	-
	BT30-S28-63	S28-FBH51-67	FBH51-1	Ø50.9 ~ Ø67.1	28	50	63	120	M10x1.0	3	-
40	BT40-S11-72	S11-FBH20-24	FBH20-1	Ø20 ~ Ø24	11	18.5	72	104.5	M5x0.8	2	-
	BT40-S14-42.5	S14-FBH24-31	FBH24-1	Ø23.9 ~ Ø31.1	14	23.5	42.5	77.5	M5x0.8	2	-
	BT40-S14-82.5	S14-FBH24-31	FBH24-1	Ø23.9 ~ Ø31.1	14	23.5	82.5	117.5	M5x0.8	2	-
	BT40-S18-44	S18-FBH31-40	FBH31-1	Ø30.9 ~ Ø40.1	18	31	44	84	M8x1.0	2	-
	BT40-S18-94	S18-FBH31-40	FBH31-1	Ø30.9 ~ Ø40.1	18	31	94	134	M8x1.0	2	-
	BT40-S22-47	S22-FBH40-51	FBH40-1	Ø39.9 ~ Ø51.1	22	39	47	94	M8x1.0	2	-
	BT40-S22-88	S22-FBH40-51	FBH40-1	Ø39.9 ~ Ø51.1	22	39	88	135	M8x1.0	2	-
	BT40-S28-50	S28-FBH51-67	FBH51-1	Ø50.9 ~ Ø67.1	28	50	50	107	M10x1.0	2	-
40	BT40-S36-64	S36-FBH67-125	FBH6787-1	Ø66.9 ~ 87.1	36	64	64	135	M16x1.5	3	-
			FBH6787-2	Ø84.9 ~ 105.1							-
			FBH6787-3	Ø104.9 ~ 125.1							-
	BT40-S46-90	S46-FBH87-154	FBH6787-1	Ø86.9 ~ 116.1	46	90	90	177	M16x1.5	3	-
		FBH6787-2	Ø104.9 ~ 134.1							-	
		FBH6787-3	Ø124.9 ~ 154.1							-	

- ▶ This is for help selecting Fine Boring Head & Insert Holder.
- ▶ The Insert Holder Clamp Screw is supplied with Boring Head.
- ▶ The Insert Screw is supplied with Insert Holder.
- ▶ The Torx Wrench should be ordered. Please contact us to purchase this wrench.
- ▶ The Basic Holder, Boring Head & Insert Holder must be ordered separately.
- ▶ The L, L1 dimensions in the table are the reference values when Boring Head and Insert Holder are mounted.

▶ NEXT PAGE

YIG TYPICAL CONFIGURATION OF FINE BORING BAR

FBH

FINE BORING BAR (SMALL BORE)

FEINBOHRHALTER
 BARRE D'ALÉSAGE FIN
 BARRE DI ALESATURA FINE
 BARRA DE MANDRINADO FINO

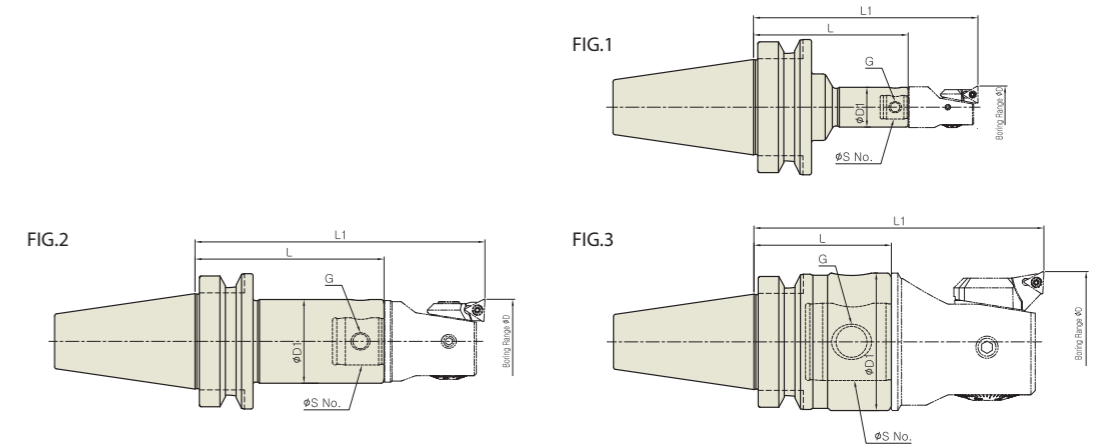

BT (JIS B6339/MAS 403/ISO 7388-2)

Unit : mm

TAPER No.	BASIC HOLDER	FINE BORING HEAD	INSERT HOLDER	BORE RANGE (ØD)	S No.	D1	L	L1	G	FIG.	WEIGHT (Kg)	
50	BT50-S11-102	S11-FBH20-24	FBH20-1	Ø20 ~ Ø24	11	18.5	102	134.5	M5x0.8	1	-	
	BT50-S14-52.5	S14-FBH24-31	FBH24-1	Ø23.9 ~ Ø31.1	14	23.5	52.5	87.5	M5x0.8	2	-	
	BT50-S14-112.5	S14-FBH24-31	FBH24-1	Ø23.9 ~ Ø31.1	14	23.5	112.5	147.5	M5x0.8	2	-	
	BT50-S18-54	S18-FBH31-40	FBH31-1	Ø30.9 ~ Ø40.1	18	31	54	94	M8x1.0	2	-	
	BT50-S18-124	S18-FBH31-40	FBH31-1	Ø30.9 ~ Ø40.1	18	31	124	164	M8x1.0	2	-	
	BT50-S22-58	S22-FBH40-51	FBH40-1	Ø39.9 ~ Ø51.1	22	39	58	105	M8x1.0	2	-	
	BT50-S22-118	S22-FBH40-51	FBH40-1	Ø39.9 ~ Ø51.1	22	39	118	165	M8x1.0	2	-	
	BT50-S22-178	S22-FBH40-51	FBH40-1	Ø39.9 ~ Ø51.1	22	39	178	225	M8x1.0	2	-	
	BT50-S28-63	S28-FBH51-67	FBH51-1	Ø50.9 ~ Ø67.1	28	50	63	120	M10x1.0	2	-	
	BT50-S28-108	S28-FBH51-67	FBH51-1	Ø50.9 ~ Ø67.1	28	50	108	165	M10x1.0	2	-	
	BT50-S28-183	S28-FBH51-67	FBH51-1	Ø50.9 ~ Ø67.1	28	50	183	240	M10x1.0	2	-	
	BT50-S28-228	S28-FBH51-67	FBH51-1	Ø50.9 ~ Ø67.1	28	50	228	285	M10x1.0	2	-	
	50	BT50-S36-94	S36-FBH67-125	FBH6787-1	Ø66.9 ~ 87.1	36	64	94	165	M16x1.5	2	-
				FBH6787-2	Ø84.9 ~ 105.1							-
				FBH6787-3	Ø104.9 ~ 125.1							-
	50	BT50-S36-169	S36-FBH67-125	FBH6787-1	Ø66.9 ~ 87.1	36	64	169	240	M16x1.5	2	-
FBH6787-2				Ø84.9 ~ 105.1	-							
FBH6787-3				Ø104.9 ~ 125.1	-							
50	BT50-S36-229	S36-FBH67-125	FBH6787-1	Ø66.9 ~ 87.1	36	64	229	300	M16x1.5	2	-	
			FBH6787-2	Ø84.9 ~ 105.1							-	
			FBH6787-3	Ø104.9 ~ 125.1							-	
50	BT50-S46-93	S46-FBH87-154	FBH6787-1	Ø86.9 ~ 116.1	46	90	93	180	M16x1.5	2	-	
			FBH6787-2	Ø104.9 ~ 134.1							-	
			FBH6787-3	Ø124.9 ~ 154.1							-	
			FBH6787-1	Ø86.9 ~ 116.1							-	
50	BT50-S46-243	S46-FBH87-154	FBH6787-2	Ø104.9 ~ 134.1	46	90	243	330	M16x1.5	2	-	
			FBH6787-3	Ø124.9 ~ 154.1							-	
			FBH6787-1	Ø86.9 ~ 116.1							-	

- ▶ This is for help selecting Fine Boring Head & Insert Holder.
- ▶ The Insert Holder Clamp Screw is supplied with Boring Head.
- ▶ The Insert Screw is supplied with Insert Holder.
- ▶ The Torx Wrench should be ordered. Please contact us to purchase this wrench.
- ▶ The Basic Holder, Boring Head & Insert Holder must be ordered separately.
- ▶ The L, L1 dimensions in the table are the reference values when Boring Head and Insert Holder are mounted.

SK (DIN 69871)

CBT (BT DUAL CONTACT)

BT (JIS B6339/MAS 403)

HSK (DIN 69893/ISO 12164)

STRAIGHT

ISO, NT, MT/MTB, GOST

TOOL HOLDER SET

BORING SYSTEM

ACCESSORY & PARTS

YG TYPICAL CONFIGURATION OF FINE BORING BAR

FBH

FINE BORING BAR (SMALL BORE)

FEINBOHRHALTER
 BARRE D'ALÉSAGE FIN
 BARRE DI ALESATURA FINE
 BARRA DE MANDRINADO FINO

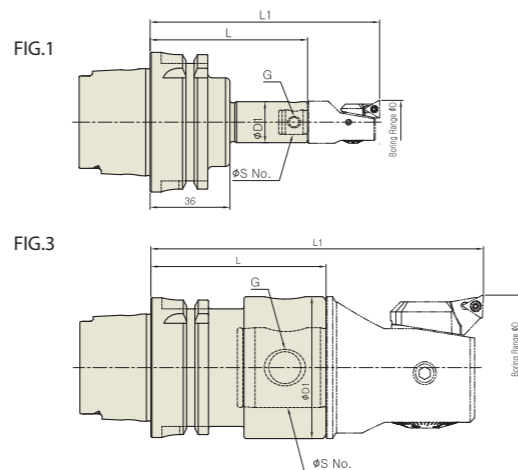

HSK-A (DIN 69893/ISO 12164)

Unit : mm

TAPER No.	BASIC HOLDER	FINE BORING HEAD	INSERT HOLDER	BORE RANGE (ØD)	S No.	D1	L	L1	G	FIG.	WEIGHT (Kg)
40A	HSK40A-S11-72.5	S11-FBH20-24	FBH20-1	Ø20 ~ Ø24	11	18.5	72.5	104.5	M5x0.8	2	-
	HSK40A-S14-39.5	S14-FBH24-31	FBH24-1	Ø23.9 ~ Ø31.1	14	23.5	39.5	74.5	M5x0.8	2	-
	HSK40A-S14-84.5	S14-FBH24-31	FBH24-1	Ø23.9 ~ Ø31.1	14	23.5	84.5	119.5	M5x0.8	2	-
	HSK40A-S18-45	S18-FBH31-40	FBH31-1	Ø30.9 ~ Ø40.1	18	31	45	85	M8x1.0	2	-
	HSK40A-S18-80	S18-FBH31-40	FBH31-1	Ø30.9 ~ Ø40.1	18	31	80	120	M8x1.0	2	-
	HSK40A-S22-53	S22-FBH40-51	FBH40-1	Ø39.9 ~ Ø51.1	22	39	53	100	M8x1.0	3	-
	HSK40A-S22-73	S22-FBH40-51	FBH40-1	Ø39.9 ~ Ø51.1	22	39	73	120	M8x1.0	3	-
50A	HSK50A-S11-72.5	S11-FBH20-24	FBH20-1	Ø20 ~ Ø24	11	18.5	72.5	104.5	M5x0.8	2	-
	HSK50A-S14-84.5	S14-FBH24-31	FBH24-1	Ø23.9 ~ Ø31.1	14	23.5	84.5	119.5	M5x0.8	2	-
	HSK50A-S18-80	S18-FBH31-40	FBH31-1	Ø30.9 ~ Ø40.1	18	31	80	120	M8x1.0	2	-
	HSK50A-S22-73	S22-FBH40-51	FBH40-1	Ø39.9 ~ Ø51.1	22	39	73	120	M8x1.0	3	-
	HSK50A-S28-83	S28-FBH51-67	FBH51-1	Ø50.9 ~ Ø67.1	28	50	83	140	M10x1.0	3	-
63A	HSK63A-S11-77.5	S11-FBH20-24	FBH20-1	Ø20 ~ Ø24	11	18.5	77.5	110	M5x0.8	2	-
	HSK63A-S14-89.5	S14-FBH24-31	FBH24-1	Ø23.9 ~ Ø31.1	14	23.5	89.5	124.5	M5x0.8	2	-
	HSK63A-S18-100	S18-FBH31-40	FBH31-1	Ø30.9 ~ Ø40.1	18	31	100	140	M8x1.0	2	-
	HSK63A-S22-93	S22-FBH40-51	FBH40-1	Ø39.9 ~ Ø51.1	22	39	93	140	M8x1.0	2	-
	HSK63A-S28-83	S28-FBH51-67	FBH51-1	Ø50.9 ~ Ø67.1	28	50	83	140	M10x1.0	2	-
	HSK63A-S36-79	S36-FBH67-125	FBH6787-1	Ø66.9 ~ Ø87.1	36	64	79	150	M16x1.5	3	-
			FBH6787-2	Ø84.9 ~ Ø105.1							-
			FBH6787-3	Ø104.9 ~ Ø125.1							-
	HSK63A-S46-100	S46-FBH87-154	FBH6787-1	Ø86.9 ~ Ø116.1	46	90	100	187	M16x1.5	3	-
			FBH6787-2	Ø104.9 ~ Ø134.1							-
FBH6787-3			Ø124.9 ~ Ø154.1	-							

- ▶ This is for help selecting Fine Boring Head & Insert Holder.
- ▶ The Insert Holder Clamp Screw is supplied with Boring Head.
- ▶ The Insert Screw is supplied with Insert Holder.
- ▶ The Torx Wrench should be ordered. Please contact us to purchase this wrench.
- ▶ The Basic Holder, Boring Head & Insert Holder must be ordered separately.
- ▶ The L, L1 dimensions in the table are the reference values when Boring Head and Insert Holder are mounted.

▶ NEXT PAGE

YG TYPICAL CONFIGURATION OF FINE BORING BAR

FBH

FINE BORING BAR (SMALL BORE)

FEINBOHRHALTER
 BARRE D'ALÉSAGE FIN
 BARRE DI ALESATURA FINE
 BARRA DE MANDRINADO FINO

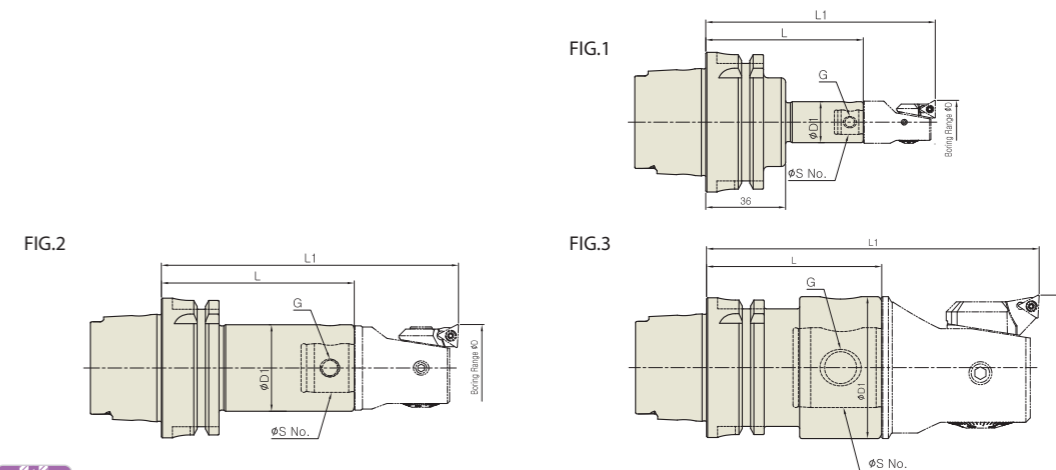

HSK-A (DIN 69893/ISO 12164)

Unit : mm

TAPER No.	BASIC HOLDER	FINE BORING HEAD	INSERT HOLDER	BORE RANGE (ØD)	S No.	D1	L	L1	G	FIG.	WEIGHT (Kg)
100A	HSK100A-S11-102.5	S11-FBH20-24	FBH20-1	Ø20 ~ Ø24	11	18.5	102.5	135	M5x0.8	1	-
	HSK100A-S14-114.5	S14-FBH24-31	FBH24-1	Ø23.9 ~ Ø31.1	14	23.5	114.5	149.5	M5x0.8	1	-
	HSK100A-S18-125	S18-FBH31-40	FBH31-1	Ø30.9 ~ Ø40.1	18	31	125	165	M8x1.0	1	-
	HSK100A-S22-118	S22-FBH40-51	FBH40-1	Ø39.9 ~ Ø51.1	22	39	118	165	M8x1.0	2	-
	HSK100A-S22-178	S22-FBH40-51	FBH40-1	Ø39.9 ~ Ø51.1	22	39	178	225	M8x1.0	2	-
	HSK100A-S28-108	S28-FBH51-67	FBH51-1	Ø50.9 ~ Ø67.1	28	50	108	165	M10x1.0	2	-
	HSK100A-S28-183	S28-FBH51-67	FBH51-1	Ø50.9 ~ Ø67.1	28	50	183	240	M10x1.0	2	-
	HSK100A-S28-228	S28-FBH51-67	FBH51-1	Ø50.9 ~ Ø67.1	28	50	228	285	M10x1.0	2	-
	HSK100A-S36-94	S36-FBH67-125	FBH6787-1	Ø66.9 ~ Ø87.1	36	64	94	165	M16x1.5	2	-
			FBH6787-2	Ø84.9 ~ Ø105.1							-
FBH6787-3			Ø104.9 ~ Ø125.1	-							
HSK100A-S36-169	S36-FBH67-125	FBH6787-1	Ø66.9 ~ Ø87.1	36	64	169	240	M16x1.5	2	-	
		FBH6787-2	Ø84.9 ~ Ø105.1							-	
		FBH6787-3	Ø104.9 ~ Ø125.1							-	
HSK100A-S36-229	S36-FBH67-125	FBH6787-1	Ø66.9 ~ Ø87.1	36	64	229	300	M16x1.5	2	-	
		FBH6787-2	Ø84.9 ~ Ø105.1							-	
		FBH6787-3	Ø104.9 ~ Ø125.1							-	
HSK100A-S46-123	S46-FBH87-154	FBH6787-1	Ø86.9 ~ Ø116.1	46	90	123	210	M16x1.5	2	-	
		FBH6787-2	Ø104.9 ~ Ø134.1							-	
		FBH6787-3	Ø124.9 ~ Ø154.1							-	
HSK100A-S46-273	S46-FBH87-154	FBH6787-1	Ø86.9 ~ Ø116.1	46	90	273	360	M16x1.5	2	-	
		FBH6787-2	Ø104.9 ~ Ø134.1							-	
		FBH6787-3	Ø124.9 ~ Ø154.1							-	

- ▶ This is for help selecting Fine Boring Head & Insert Holder.
- ▶ The Insert Holder Clamp Screw is supplied with Boring Head.
- ▶ The Insert Screw is supplied with Insert Holder.
- ▶ The Torx Wrench should be ordered. Please contact us to purchase this wrench.
- ▶ The Basic Holder, Boring Head & Insert Holder must be ordered separately.
- ▶ The L, L1 dimensions in the table are the reference values when Boring Head and Insert Holder are mounted.

YG TYPICAL CONFIGURATION OF ROUGH BORING BAR

TBH

ROUGH BORING BAR (SMALL BORE)

DOPPELBOHRHALTER
 BARRE D'ALÉSAGE JUMENTAUX
 BARRE DI ALESATURA GEMELLO
 BARRA DE MANDRINAR MELLIZO

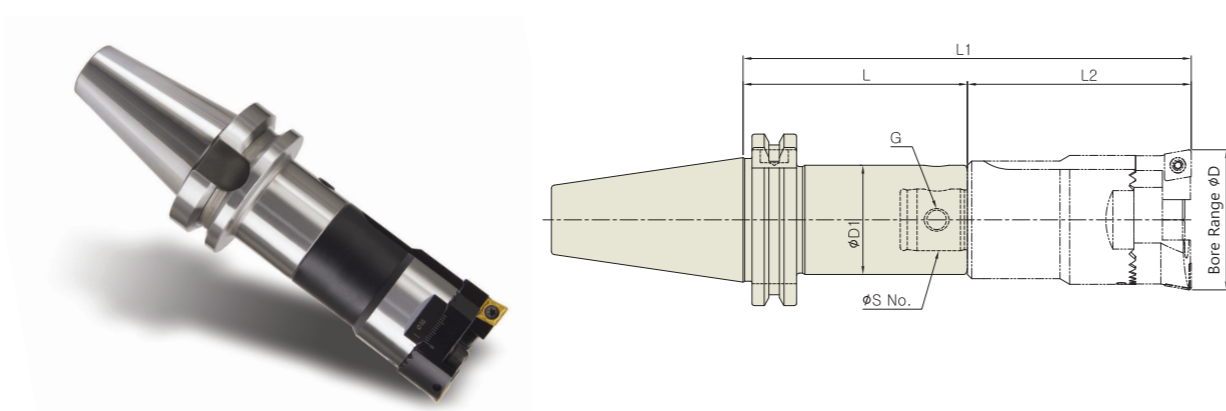

SK (DIN 69871)

Unit : mm

TAPER No.	BASIC HOLDER	ROUGH BORING HEAD	CARTRIDGE	BORE RANGE (ØD)	S No.	L1	L2	G	WEIGHT (Kg)
40	SK40-S11-72	S11-TBH25-34	TBH25-34	Ø25 ~ Ø34	11	112	50	M5x0.8	-
	SK40-S18-44	S18-TBH34-51	TBH34-43N	Ø34 ~ Ø43	18	104	60	M8x1.0	-
			TBH42-51N	Ø42 ~ Ø51					-
	SK40-S18-94	S18-TBH34-51	TBH34-43N	Ø34 ~ Ø43	18	154	60	M8x1.0	-
			TBH42-51N	Ø42 ~ Ø51					-
	SK40-S22-43	S22-TBH50-77	TBH50-64N	Ø50 ~ Ø64	22	123	80	M8x1.0	-
			TBH63-77N	Ø63 ~ Ø77					-
	SK40-S22-88	S22-TBH50-77	TBH50-64N	Ø50 ~ Ø64	22	168	80	M8x1.0	-
			TBH63-77N	Ø63 ~ Ø77					-
	SK40-S36-64	S36-TBH76-116	TBH76-97N	Ø76 ~ Ø97	36	174	110	M16x1.5	-
			TBH95-116N	Ø95 ~ Ø116					-
	SK40-S46-90	S46-TBH115-156	TBH115-136N	Ø115 ~ Ø136	46	195	105	M16x1.5	-
TBH135-156N			Ø135 ~ Ø156	-					
50	SK50-S11-102	S11-TBH25-34	TBH25-34	Ø25 ~ Ø34	11	152	50	M5x0.8	-
	SK50-S18-54	S18-TBH34-51	TBH34-43N	Ø34 ~ Ø43	18	114	60	M8x1.0	-
			TBH42-51N	Ø42 ~ Ø51					-
	SK50-S18-124	S18-TBH34-51	TBH34-43N	Ø34 ~ Ø43	18	184	60	M8x1.0	-
			TBH42-51N	Ø42 ~ Ø51					-
	SK50-S22-58	S22-TBH50-77	TBH50-64N	Ø50 ~ Ø64	22	138	80	M8x1.0	-
			TBH63-77N	Ø63 ~ Ø77					-
	SK50-S22-178	S22-TBH50-77	TBH50-64N	Ø50 ~ Ø64	22	258	80	M8x1.0	-
			TBH63-77N	Ø63 ~ Ø77					-
	SK50-S36-94	S36-TBH76-116	TBH76-97N	Ø76 ~ Ø97	36	204	110	M16x1.5	-
			TBH95-116N	Ø95 ~ Ø116					-
	SK50-S46-93	S46-TBH115-156	TBH115-136N	Ø115 ~ Ø136	46	198	105	M16x1.5	-
TBH135-156N			Ø135 ~ Ø156	-					

- ▶ This is for help selecting Rough Boring Head & Cartridge.
- ▶ The Cartridge Clamp Screw is supplied with Boring Head.
- ▶ The Insert Screw is supplied with Cartridge.
- ▶ The Torx Wrench should be ordered. Please contact us to purchase this wrench.
- ▶ The Basic Holder, Rough Boring Head & Cartridge must be ordered separately.
- ▶ The L1, L2 dimensions in the table are the reference values when Boring Head and Cartridge are mounted.

YG TYPICAL CONFIGURATION OF ROUGH BORING BAR

TBH

ROUGH BORING BAR (SMALL BORE)

DOPPELBOHRHALTER
 BARRE D'ALÉSAGE JUMENTAUX
 BARRE DI ALESATURA GEMELLO
 BARRA DE MANDRINAR MELLIZO

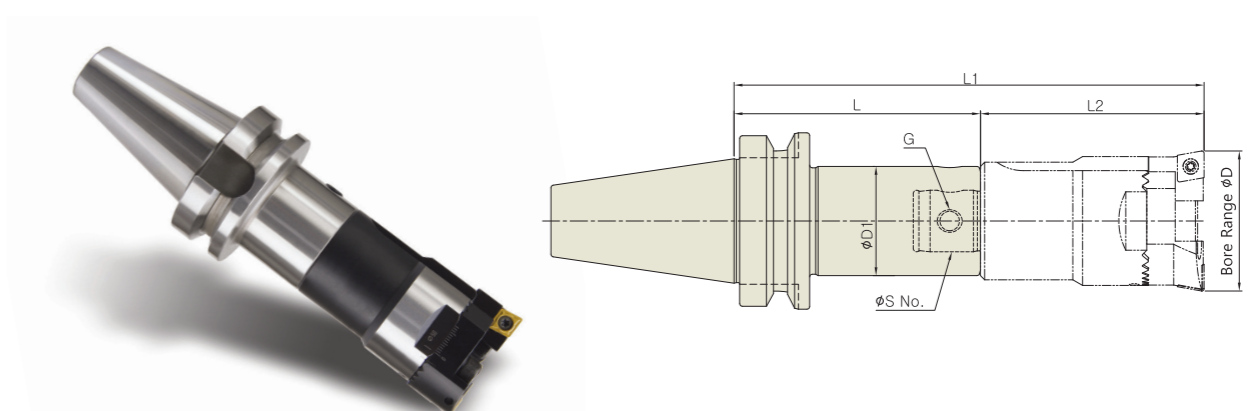

BT (JIS B6339/MAS 403)

Unit : mm

TAPER No.	BASIC HOLDER	ROUGH BORING HEAD	CARTRIDGE	BORE RANGE (ØD)	S No.	L1	L2	G	WEIGHT (Kg)	
30	BT30-S11-72	S11-TBH25-34	TBH25-34	Ø25 ~ Ø34	11	122	50	M5x0.8	-	
	BT30-S18-39	S18-TBH34-51	TBH34-43N	Ø34 ~ Ø43	18	99	60	M8x1.0	-	
			TBH42-51N	Ø42 ~ Ø51					-	
	BT30-S18-79	S18-TBH34-51	TBH34-43N	Ø34 ~ Ø43	18	139	60	M8x1.0	-	
			TBH42-51N	Ø42 ~ Ø51					-	
	BT30-S22-38	S22-TBH50-77	TBH50-64N	Ø50 ~ Ø64	22	118	80	M8x1.0	-	
			TBH63-77N	Ø63 ~ Ø77					-	
	BT30-S22-73	S22-TBH50-77	TBH50-64N	Ø50 ~ Ø64	22	153	80	M8x1.0	-	
			TBH63-77N	Ø63 ~ Ø77					-	
	40	BT40-S11-72	S11-TBH25-34	TBH25-34	Ø25 ~ Ø34	11	122	50	M5x0.8	-
		BT40-S18-44	S18-TBH34-51	TBH34-43N	Ø34 ~ Ø43	18	104	60	M8x1.0	-
				TBH42-51N	Ø42 ~ Ø51					-
BT40-S18-94		S18-TBH34-51	TBH34-43N	Ø34 ~ Ø43	18	154	60	M8x1.0	-	
			TBH42-51N	Ø42 ~ Ø51					-	
BT40-S22-47		S22-TBH50-77	TBH50-64N	Ø50 ~ Ø64	22	127	80	M8x1.0	-	
			TBH63-77N	Ø63 ~ Ø77					-	
BT40-S22-88		S22-TBH50-77	TBH50-64N	Ø50 ~ Ø64	22	168	80	M8x1.0	-	
			TBH63-77N	Ø63 ~ Ø77					-	
BT40-S36-64		S36-TBH76-116	TBH76-97N	Ø76 ~ Ø97	36	174	110	M16x1.5	-	
			TBH95-116N	Ø95 ~ Ø116					-	
BT40-S36-64		S36-TBH115-156	TBH115-136N	Ø115 ~ Ø136	36	169	110	M16x1.5	-	
	TBH135-156N		Ø135 ~ Ø156	-						

- ▶ This is for help selecting Rough Boring Head & Cartridge.
- ▶ The Cartridge Clamp Screw is supplied with Boring Head.
- ▶ The Insert Screw is supplied with Cartridge.
- ▶ The Torx Wrench should be ordered. Please contact us to purchase this wrench.
- ▶ The Basic Holder, Rough Boring Head & Cartridge must be ordered separately.
- ▶ The L1, L2 dimensions in the table are the reference values when Boring Head and Cartridge are mounted.

▶ NEXT PAGE

YG TYPICAL CONFIGURATION OF ROUGH BORING BAR

TBH

ROUGH BORING BAR (SMALL BORE)

DOPPELBOHRHALTER
 BARRE D'ALÉSAGE JUMEAUX
 BARRE DI ALESATURA GEMELLO
 BARRA DE MANDRINAR MELLIZO

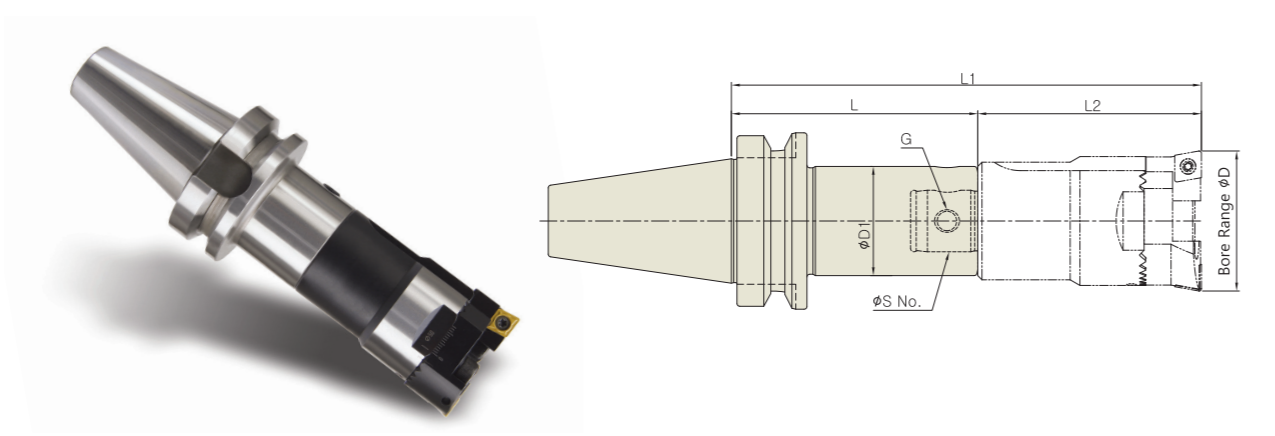

BT (JIS B6339/MAS 403)

Unit : mm

TAPER No.	BASIC HOLDER	ROUGH BORING HEAD	CARTRIDGE	BORE RANGE (ØD)	S No.	L1	L2	G	WEIGHT (Kg)
50	BT50-S11-102	S11-TBH25-34	TBH25-34	Ø25 ~ Ø34	11	152	50	M5x0.8	-
	BT50-S18-54	S18-TBH34-51	TBH34-43N	Ø34 ~ Ø43	18	114	60	M8x1.0	-
			TBH42-51N	Ø42 ~ Ø51					
	BT50-S18-124	S18-TBH34-51	TBH34-43N	Ø34 ~ Ø43	18	184	60	M8x1.0	-
			TBH42-51N	Ø42 ~ Ø51					
	BT50-S22-58	S22-TBH50-77	TBH50-64N	Ø50 ~ Ø64	22	138	80	M8x1.0	-
			TBH63-77N	Ø63 ~ Ø77					
	BT50-S22-118	S22-TBH50-77	TBH50-64N	Ø50 ~ Ø64	22	198	80	M8x1.0	-
			TBH63-77N	Ø63 ~ Ø77					
	BT50-S22-178	S22-TBH50-77	TBH50-64N	Ø50 ~ Ø64	22	258	80	M8x1.0	-
			TBH63-77N	Ø63 ~ Ø77					
	BT50-S36-94	S36-TBH76-116	TBH76-97N	Ø76 ~ Ø97	36	204	110	M16x1.5	-
			TBH95-116N	Ø95 ~ Ø116					
	BT50-S36-169	S36-TBH76-116	TBH76-97N	Ø76 ~ Ø97	36	179	110	M16x1.5	-
			TBH95-116N	Ø95 ~ Ø116					
	BT50-S36-229	S36-TBH76-116	TBH76-97N	Ø76 ~ Ø97	36	339	110	M16x1.5	-
			TBH95-116N	Ø95 ~ Ø116					
	BT50-S46-93	S46-TBH115-156	TBH115-136N	Ø115 ~ Ø136	46	198	105	M16x1.5	-
		TBH135-156N	Ø135 ~ Ø156						

- ▶ This is for help selecting Rough Boring Head & Cartridge.
- ▶ The Cartridge Clamp Screw is supplied with Boring Head.
- ▶ The Insert Screw is supplied with Cartridge.
- ▶ The Torx Wrench should be ordered. Please contact us to purchase this wrench.
- ▶ The Basic Holder, Rough Boring Head & Cartridge must be ordered separately.
- ▶ The L1, L2 dimensions in the table are the reference values when Boring Head and Cartridge are mounted.

YG TYPICAL CONFIGURATION OF ROUGH BORING BAR

TBH

ROUGH BORING BAR (SMALL BORE)

DOPPELBOHRHALTER
 BARRE D'ALÉSAGE JUMEAUX
 BARRE DI ALESATURA GEMELLO
 BARRA DE MANDRINAR MELLIZO

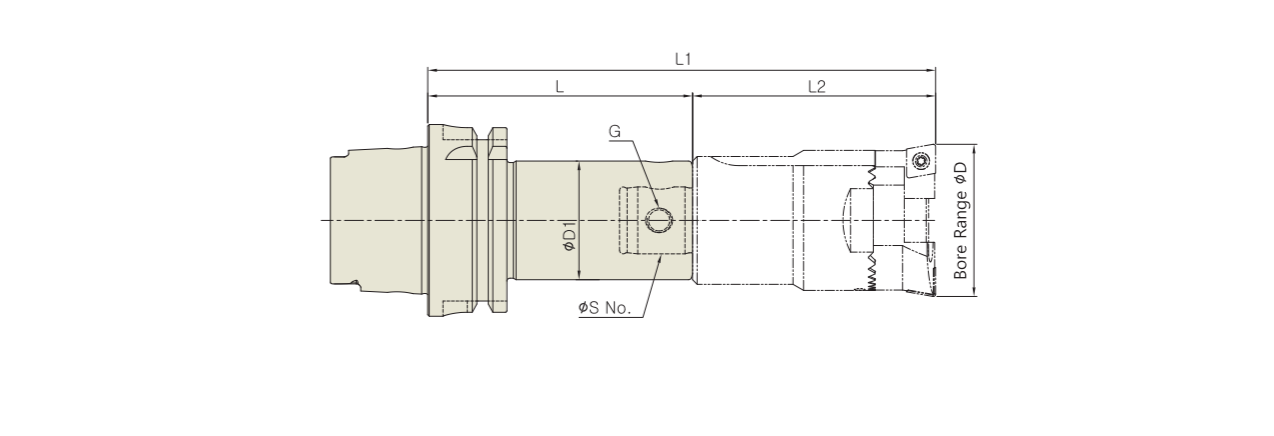

HSK (DIN 69893/ISO 12164)

Unit : mm

TAPER No.	BASIC HOLDER	ROUGH BORING HEAD	CARTRIDGE	BORE RANGE (ØD)	S No.	L1	L2	G	WEIGHT (Kg)	
40A	HSK40A-S11-72.5	S11-TBH25-34	TBH25-34	Ø25 ~ Ø34	11	122.5	50	M5x0.8	-	
	HSK40A-S18-45	S18-TBH34-51	TBH34-43N	Ø34 ~ Ø43	18	105	60	M8x1.0	-	
			TBH42-51N	Ø42 ~ Ø51						
	HSK40A-S18-80	S18-TBH34-51	TBH34-43N	Ø34 ~ Ø43	18	140	60	M8x1.0	-	
			TBH42-51N	Ø42 ~ Ø51						
	HSK40A-S22-53	S22-TBH50-77	TBH50-64N	Ø50 ~ Ø64	22	133	80	M8x1.0	-	
			TBH63-77N	Ø63 ~ Ø77						
	HSK40A-S22-73	S22-TBH50-77	TBH50-64N	Ø50 ~ Ø64	22	153	80	M8x1.0	-	
			TBH63-77N	Ø63 ~ Ø77						
	50A	HSK50A-S11-72.5	S11-TBH25-34	FBH20-1	Ø20 ~ Ø24	11	122.5	50	M5x0.8	-
		HSK50A-S18-80	S18-TBH34-51	TBH34-43N	Ø34 ~ Ø43	18	140	60	M8x1.0	-
				TBH42-51N	Ø42 ~ Ø51					
HSK50A-S22-73		S22-TBH50-77	TBH50-64N	Ø50 ~ Ø64	22	153	80	M8x1.0	-	
			TBH63-77N	Ø63 ~ Ø77						
HSK50A-S36-79		S36-TBH76-116	TBH76-97N	Ø76 ~ Ø97	36	189	110	M16x1.5	-	
	TBH95-116N		Ø95 ~ Ø116							
63A	HSK63A-S11-77.5	S11-TBH25-34	TBH25-34	Ø25 ~ Ø34	11	127.5	50	M5x0.8	-	
	HSK63A-S18-100	S18-TBH34-51	TBH34-43N	Ø34 ~ Ø43	18	160	60	M8x1.0	-	
			TBH42-51N	Ø42 ~ Ø51						
	HSK63A-S22-93	S22-TBH50-77	TBH50-64N	Ø50 ~ Ø64	22	173	80	M8x1.0	-	
			TBH63-77N	Ø63 ~ Ø77						
	HSK63A-S36-79	S36-TBH76-116	TBH76-97N	Ø76 ~ Ø97	36	189	110	M16x1.5	-	
TBH95-116N			Ø95 ~ Ø116							

- ▶ This is for help selecting Rough Boring Head & Cartridge.
- ▶ The Cartridge Clamp Screw is supplied with Boring Head.
- ▶ The Insert Screw is supplied with Cartridge.
- ▶ The Torx Wrench should be ordered. Please contact us to purchase this wrench.
- ▶ The Basic Holder, Rough Boring Head & Cartridge must be ordered separately.
- ▶ The L1, L2 dimensions in the table are the reference values when Boring Head and Cartridge are mounted.

▶ NEXT PAGE

YIG TYPICAL CONFIGURATION OF ROUGH BORING BAR

TBH

ROUGH BORING BAR (SMALL BORE)

DOPPELBOHRHALTER
 BARRE D'ALÉSAGE JUMEAUX
 BARRE DI ALESATURA GEMELLO
 BARRA DE MANDRINAR MELLIZO

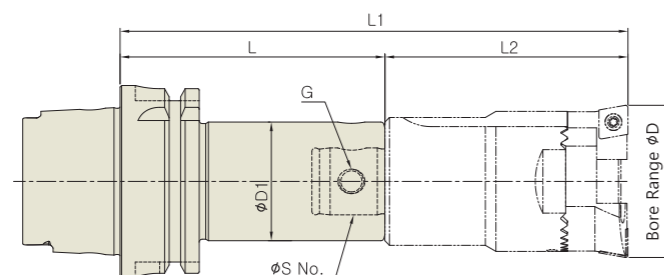

HSK (DIN 69893/ISO 12164)

Unit : mm

TAPER No.	BASIC HOLDER	ROUGH BORING HEAD	CARTRIDGE	BORE RANGE (ØD)	S No.	L1	L2	G	WEIGHT (Kg)				
100A	HSK100A-S11-102.5	S11-FBH20-24	FBH20-1	Ø20 ~ Ø24	11	152.5	50	M5x0.8	-				
	HSK100A-S18-125	S18-TBH34-51	TBH34-43N	Ø34 ~ Ø43	18	185	60	M8x1.0	-				
			TBH42-51N	Ø42 ~ Ø51					-				
	HSK100A-S22-118	S22-TBH50-77	TBH50-64N	Ø50 ~ Ø64	22	198	80	M8x1.0	-				
			TBH63-77N	Ø63 ~ Ø77					-				
	HSK100A-S22-178	S22-TBH50-77	TBH50-64N	Ø50 ~ Ø64	22	258	80	M8x1.0	-				
			TBH63-77N	Ø63 ~ Ø77					-				
	HSK100A-S36-94	S36-TBH76-116	TBH76-97N	Ø76 ~ Ø97	36	204	110	M16x1.5	-				
			TBH95-116N	Ø95 ~ Ø116					-				
			TBH76-97N	Ø76 ~ Ø97					36	279	110	M16x1.5	-
			TBH95-116N	Ø95 ~ Ø116									-
	HSK100A-S36-169	S36-TBH76-116	TBH76-97N	Ø76 ~ Ø97	36	279	110	M16x1.5	-				
			TBH95-116N	Ø95 ~ Ø116					-				
	HSK100A-S36-229	S36-TBH76-116	TBH76-97N	Ø76 ~ Ø97	36	339	110	M16x1.5	-				
			TBH95-116N	Ø95 ~ Ø116					-				
	HSK100A-S46-123	S46-TBH115-156	TBH115-136N	Ø115 ~ Ø136	46	228	105	M16x1.5	-				
			TBH135-156N	Ø135 ~ Ø156					-				
	HSK100A-S46-273	S46-TBH115-156	TBH115-136N	Ø115 ~ Ø136	46	378	105	M16x1.5	-				
TBH135-156N			Ø135 ~ Ø156	-									

- ▶ This is for help selecting Rough Boring Head & Cartridge.
- ▶ The Cartridge Clamp Screw is supplied with Boring Head.
- ▶ The Insert Screw is supplied with Cartridge.
- ▶ The Torx Wrench should be ordered. Please contact us to purchase this wrench.
- ▶ The Basic Holder, Rough Boring Head & Cartridge must be ordered separately.
- ▶ The L1, L2 dimensions in the table are the reference values when Boring Head and Cartridge are mounted.

YIG ROUGH BORING BAR

TBH

ROUGH BORING BAR (SMALL BORE)

DOPPELBOHRHALTER
 BARRE D'ALÉSAGE JUMEAUX
 BARRE DI ALESATURA GEMELLO
 BARRA DE MANDRINAR MELLIZO

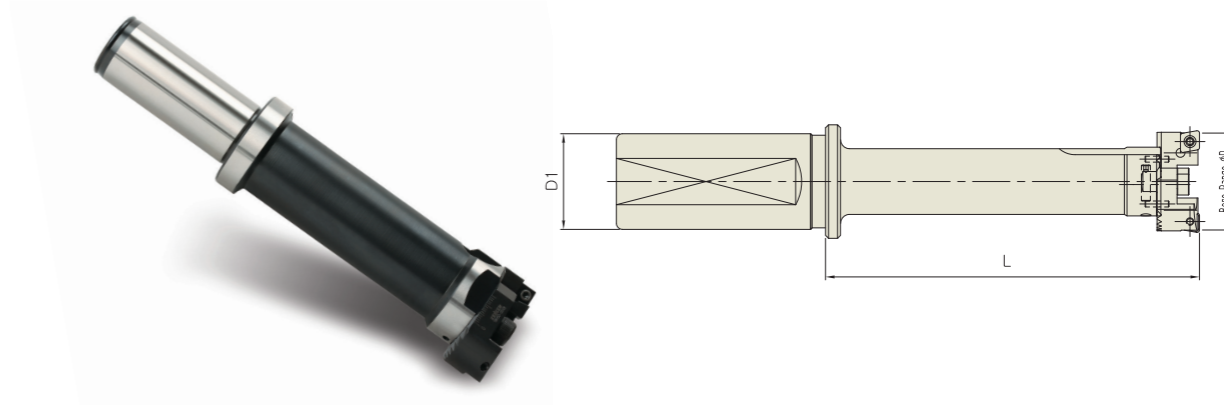

STRAIGHT-ST

Unit : mm

TAPER No.	MODEL No.	EDP No.	CARTRIDGE	BORE RANGE (ØD)	L	D1	WEIGHT (Kg)
32	ST32-TBH25-125	P2779559	TBH25-34	Ø25 ~ Ø34	125	32	-
	ST32-TBH34-130	P2779560	TBH34-43N	Ø34 ~ Ø43	130	32	-
			TBH42-51N	Ø42 ~ Ø51			-
40	ST32-TBH50-155	P2779561	TBH50-64N	Ø50 ~ Ø64	155	32	-
			TBH63-77N	Ø63 ~ Ø77			-
40	ST40-TBH76-185	P2779562	TBH76-97N	Ø76 ~ Ø97	185	40	-
			TBH95-116N	Ø95 ~ Ø116			-
42	ST42-TBH76-185	P2779563	TBH76-97N	Ø76 ~ Ø97	185	42	-
			TBH95-116N	Ø96 ~ Ø116			-

- ▶ This is for help selecting Straight Rough Boring Head & Cartridge.
- ▶ The Cartridge Clamp Screw is supplied with Boring Head.
- ▶ The Insert Screw is supplied with Cartridge.
- ▶ The Torx Wrench should be ordered. Please contact us to purchase this wrench.
- ▶ The Straight Shank & Cartridge must be ordered separately.
- ▶ The Straight Shank & Rough Boring Head are combined.
- ▶ The dimensions L in the table are the reference values when cartridge are mounted.

SK (DIN 69871)

CBT (BT DUAL CONTACT)

BT (JIS B6339/ MAS 403)

HSK (DIN 69893/ ISO 12164)

STRAIGHT

ISO, NT, MTA/MTB, GOST

TOOL HOLDER SET

BORING SYSTEM

ACCESSORY & PARTS

Boring Range : 153mm~576mm (FINE BORING BAR)
156mm~576mm (ROUGH BORING BAR)

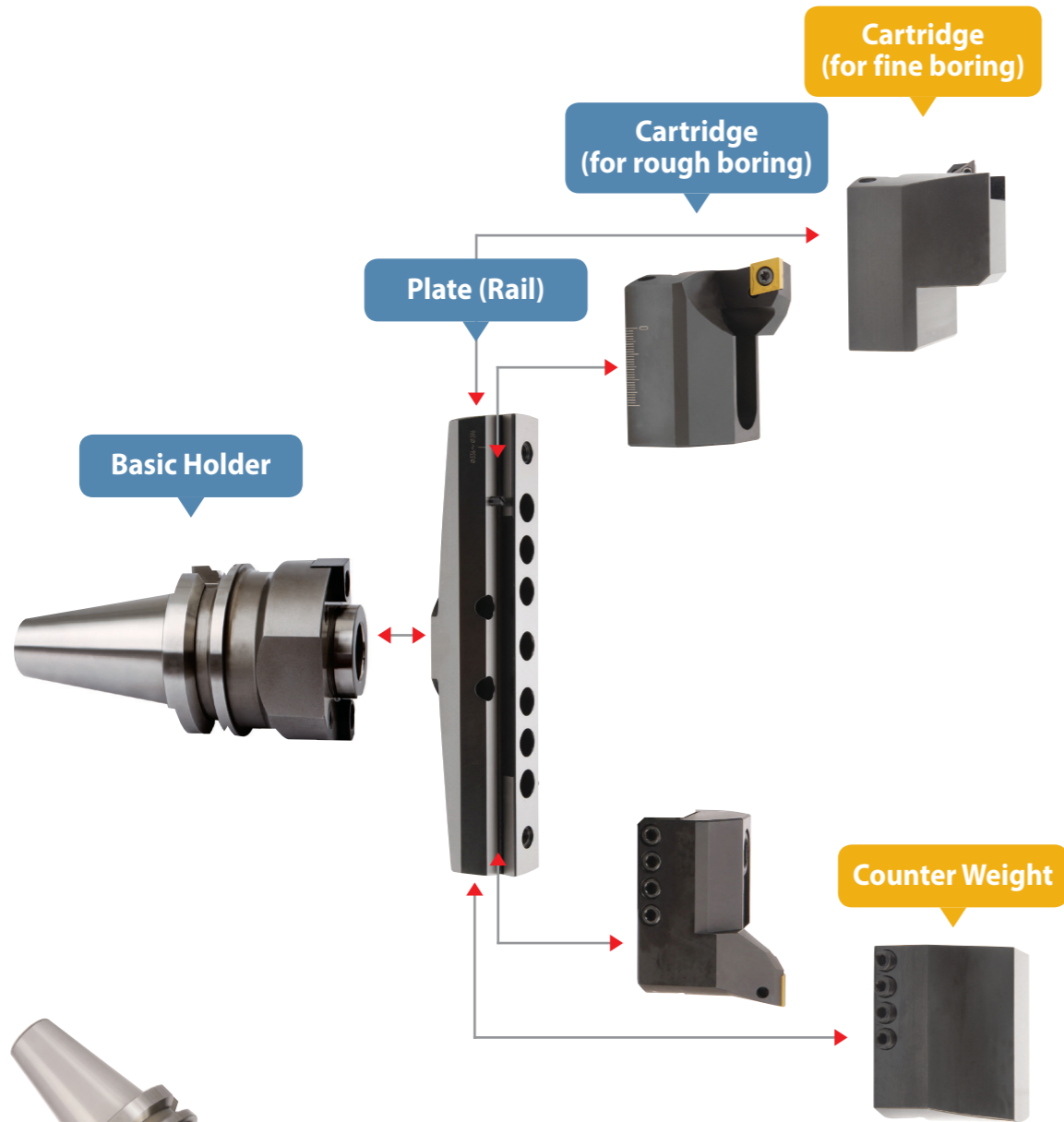

FEATURE

- Easy to replace head
- Using insert conforming to ISO standard
- Special Rough Boring Bars with a boring range up to 800mm could be manufactured
- Basic holder interchangeable between Fine Boring Bar and Rough Boring Bar

FINE & ROUGH BORING BAR (BIG BORE)

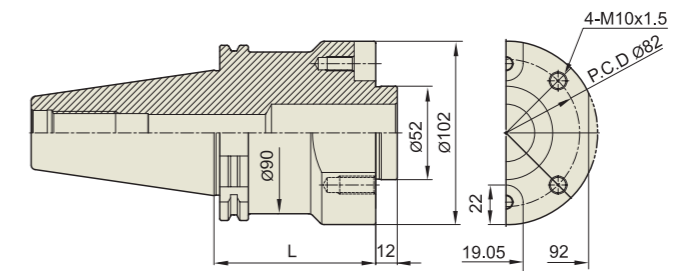

SK (DIN 69871)

Unit : mm

MODEL No.	L
SK50-SAS102-90	90
SK50-SAS102-140	140
SK50-SAS102-190	190

▶ Basic holder interchangeable between Fine Boring Bar and Rough Boring Bar.

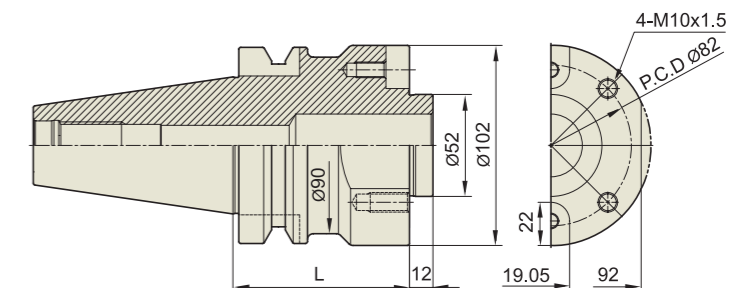

BT (JIS B6339/MAS 403)

Unit : mm

MODEL No.	L
BT50-SAS102-90	90
BT50-SAS102-140	140
BT50-SAS102-190	190

▶ Basic holder interchangeable between Fine Boring Bar and Rough Boring Bar.

FINE BORING BAR (BIG BORE)

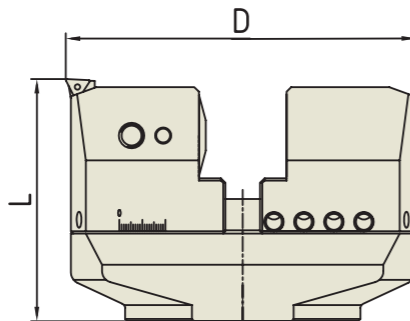

Unit : mm

MODEL No.	D (BORE RANGE)		L (HEIGHT)	WEIGHT (Kg)
	Min.	Max.		
FBH153S	153	216	105	-
FBH216S	216	276	105	-
FBH276S	276	336	105	-
FBH336S	336	396	105	-
FBH396S	396	456	105	-
FBH456S	456	516	105	-
FBH516S	516	576	105	-

SPARE PART

BORING HEAD	PLATE	CARTRIDGE	CLAMP BOLT	COUNTER WEIGHT	WRENCH	CLAMP SCREW	T-WRENCH
FBH153S	PLA153	FTP11	M10 X 30L	FBB153	L-W 5	FTNA0307	T7
FBH216S	PLA216						
FBH276S	PLA276						
FBH336S	PLA336						
FBH396S	PLA396						
FBH456S	PLA456						
FBH516S	PLA516						

ROUGH BORING BAR (BIG BORE)

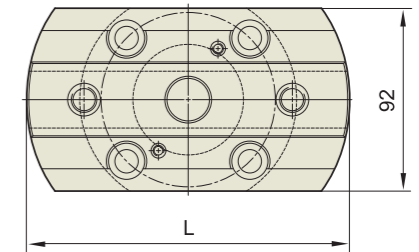

Unit : mm

PLATE	D
PLA156	152
PLA216	212
PLA276	272
PLA336	332
PLA396	392
PLA456	452
PLA516	512

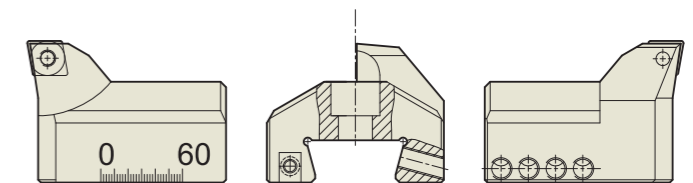
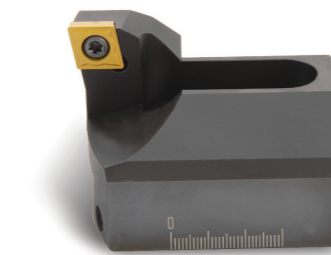

Unit : mm

for Rough Cutting
CN120

FINE BORING BAR (BIG BORE)

FEINBOHRHALTER
ALÉSAGE PROFOND
BARRE DI ALESATURA FINE
BARRA DE MANDRINADO FINO

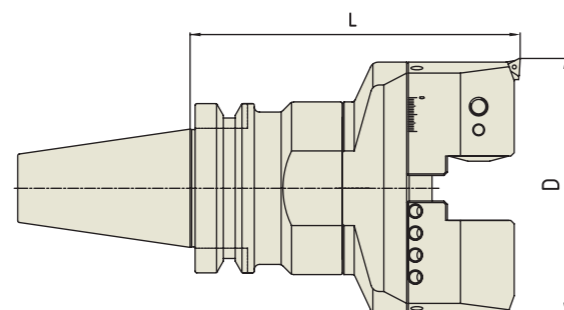

BT (JIS B6339/MAS 403)

Unit : mm

MODEL No.	D (BORE RANGE)		BODY (BASIC HOLDER)	BORING HEAD	WEIGHT (Kg)
	Min.	Max.			
BT50-FBH153-195	153	216	BT50-SAS102-90	FBH153S	-
BT50-FBH153-265			BT50-SAS102-160		-
BT50-FBH153-315			BT50-SAS102-210		-
BT50-FBH153-365			BT50-SAS102-260		-
BT50-FBH216-195	216	276	BT50-SAS102-90	FBH216S	-
BT50-FBH216-265			BT50-SAS102-160		-
BT50-FBH216-315			BT50-SAS102-210		-
BT50-FBH216-365			BT50-SAS102-260		-
BT50-FBH276-195	276	336	BT50-SAS102-90	FBH276S	-
BT50-FBH276-265			BT50-SAS102-160		-
BT50-FBH276-315			BT50-SAS102-210		-
BT50-FBH276-365			BT50-SAS102-260		-
BT50-FBH336-195	336	396	BT50-SAS102-90	FBH336S	-
BT50-FBH336-265			BT50-SAS102-160		-
BT50-FBH336-315			BT50-SAS102-210		-
BT50-FBH336-365			BT50-SAS102-260		-
BT50-FBH396-195	396	456	BT50-SAS102-90	FBH396S	-
BT50-FBH396-265			BT50-SAS102-160		-
BT50-FBH396-315			BT50-SAS102-210		-
BT50-FBH396-365			BT50-SAS102-260		-
BT50-FBH456-195	456	516	BT50-SAS102-90	FBH456S	-
BT50-FBH456-265			BT50-SAS102-160		-
BT50-FBH456-315			BT50-SAS102-210		-
BT50-FBH456-365			BT50-SAS102-260		-
BT50-FBH516-195	516	576	BT50-SAS102-90	FBH516S	-
BT50-FBH516-265			BT50-SAS102-160		-
BT50-FBH516-315			BT50-SAS102-210		-
BT50-FBH516-365			BT50-SAS102-260		-

▶ Basic holder interchangeable between Fine Boring Bar and Rough Boring Bar.

ROUGH BORING BAR (BIG BORE)

DOPPELSCHNEIDER - BOHRSTANGE
BARRE D'ALÉSAGE À 2 ARÊTES DE COUPE
PORTA TESTINE BILAMA
BARRAS DE MANDRINAR DE DOS PLACAS

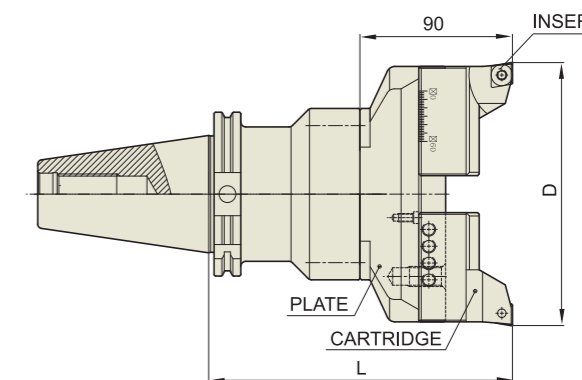

SK (DIN 69871/ISO 7388-1)

Unit : mm

MODEL No.	D (BORE RANGE)		L	BODY	PLATE	INSERT	WEIGHT (Kg)
	Min.	Max.					
SK50-TBH156-180	156 - 216		180	SK50-SAS102-90	PLA156	CCMT120400	-
SK50-TBH156-230	156 - 216		230	SK50-SAS102-140	PLA156	CCMT120400	-
SK50-TBH156-280	156 - 216		280	SK50-SAS102-190	PLA156	CCMT120400	-
SK50-TBH216-180	216 - 276		180	SK50-SAS102-90	PLA216	CCMT120400	-
SK50-TBH216-230	216 - 276		230	SK50-SAS102-140	PLA216	CCMT120400	-
SK50-TBH216-280	216 - 276		280	SK50-SAS102-190	PLA216	CCMT120400	-
SK50-TBH276-180	276 - 336		180	SK50-SAS102-90	PLA276	CCMT120400	-
SK50-TBH276-230	276 - 336		230	SK50-SAS102-140	PLA276	CCMT120400	-
SK50-TBH276-280	276 - 336		280	SK50-SAS102-190	PLA276	CCMT120400	-
SK50-TBH336-180	336 - 396		180	SK50-SAS102-90	PLA336	CCMT120400	-
SK50-TBH336-230	336 - 396		230	SK50-SAS102-140	PLA336	CCMT120400	-
SK50-TBH336-280	336 - 396		280	SK50-SAS102-190	PLA336	CCMT120400	-
SK50-TBH396-180	396 - 456		180	SK50-SAS102-90	PLA396	CCMT120400	-
SK50-TBH396-230	396 - 456		230	SK50-SAS102-140	PLA396	CCMT120400	-
SK50-TBH396-280	396 - 456		280	SK50-SAS102-190	PLA396	CCMT120400	-
SK50-TBH456-180	456 - 516		180	SK50-SAS102-90	PLA456	CCMT120400	-
SK50-TBH456-230	456 - 516		230	SK50-SAS102-140	PLA456	CCMT120400	-
SK50-TBH456-280	456 - 516		280	SK50-SAS102-190	PLA456	CCMT120400	-
SK50-TBH516-180	516 - 576		180	SK50-SAS102-90	PLA516	CCMT120400	-
SK50-TBH516-230	516 - 576		230	SK50-SAS102-140	PLA516	CCMT120400	-
SK50-TBH516-280	516 - 576		280	SK50-SAS102-190	PLA516	CCMT120400	-

▶ Upon request, special Rough Boring Bars with a boring range up to 800mm could be manufactured and supplied.
▶ Basic holder interchangeable between Fine Boring Bar and Rough Boring Bar.

ROUGH BORING BAR

TBH

ROUGH BORING BAR (BIG BORE)

DOPPELSCHNEIDER - BOHRSTANGE
 BARRE D'ALÉSAGE À 2 ARÊTES DE COUPE
 PORTA TESTINE BILAMA
 BARRAS DE MANDRINAR DE DOS PLACAS

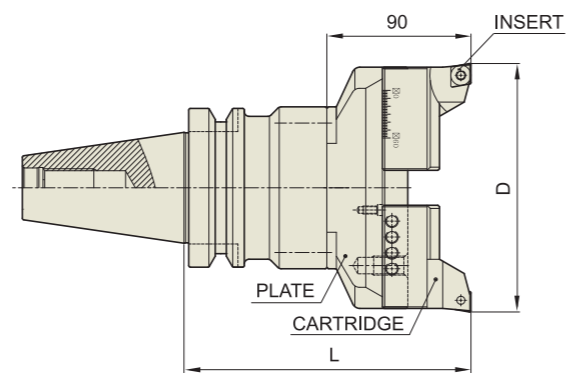

BT (JIS B6339/MAS 403)

Unit : mm

MODEL No.	D (BORE RANGE)		L	BODY	PLATE	INSERT	WEIGHT (Kg)
	Min.	Max.					
BT50-TBH156-180	156	216	180	BT50-SAS102-90	PLA156	CCMT120400	-
BT50-TBH156-230	156	216	230	BT50-SAS102-140	PLA156	CCMT120400	-
BT50-TBH156-280	156	216	280	BT50-SAS102-190	PLA156	CCMT120400	-
BT50-TBH216-180	216	276	180	BT50-SAS102-90	PLA216	CCMT120400	-
BT50-TBH216-230	216	276	230	BT50-SAS102-140	PLA216	CCMT120400	-
BT50-TBH216-280	216	276	280	BT50-SAS102-190	PLA216	CCMT120400	-
BT50-TBH276-180	276	336	180	BT50-SAS102-90	PLA276	CCMT120400	-
BT50-TBH276-230	276	336	230	BT50-SAS102-140	PLA276	CCMT120400	-
BT50-TBH276-280	276	336	280	BT50-SAS102-190	PLA276	CCMT120400	-
BT50-TBH336-180	336	396	180	BT50-SAS102-90	PLA336	CCMT120400	-
BT50-TBH336-230	336	396	230	BT50-SAS102-140	PLA336	CCMT120400	-
BT50-TBH336-280	336	396	280	BT50-SAS102-190	PLA336	CCMT120400	-
BT50-TBH396-180	396	456	180	BT50-SAS102-90	PLA396	CCMT120400	-
BT50-TBH396-230	396	456	230	BT50-SAS102-140	PLA396	CCMT120400	-
BT50-TBH396-280	396	456	280	BT50-SAS102-190	PLA396	CCMT120400	-
BT50-TBH456-180	456	516	180	BT50-SAS102-90	PLA456	CCMT120400	-
BT50-TBH456-230	456	516	230	BT50-SAS102-140	PLA456	CCMT120400	-
BT50-TBH456-280	456	516	280	BT50-SAS102-190	PLA456	CCMT120400	-
BT50-TBH516-180	516	576	180	BT50-SAS102-90	PLA516	CCMT120400	-
BT50-TBH516-230	516	576	230	BT50-SAS102-140	PLA516	CCMT120400	-
BT50-TBH516-280	516	576	280	BT50-SAS102-190	PLA516	CCMT120400	-

▶ Upon request, special Rough Boring Bars with a boring range up to 800mm could be manufactured and supplied.
 ▶ Basic holder interchangeable between Fine Boring Bar and Rough Boring Bar.

MICRO BORING BAR

BCA

MICRO BORING BAR

MIKRO - BOHRSTANGE
 BARRE D'ALÉSAGE MICRO
 PORTA TESTINE MICROREGISTRABILI
 BARRAS DE MANDRINAR MICRO

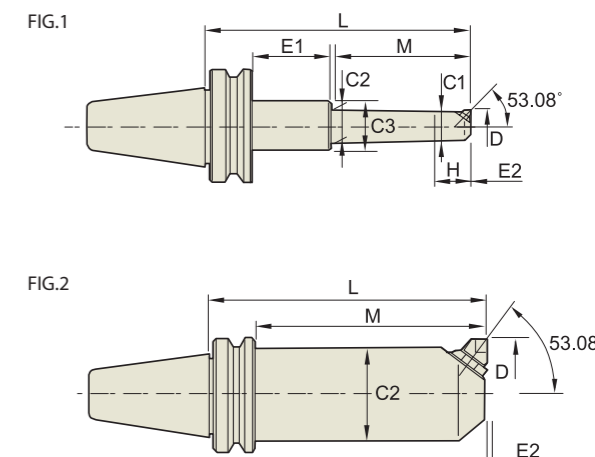

BT (JIS B6339/MAS 403)

Unit : mm

TAPER No.	MODEL No.	D (BORE RANGE)		L	M	C1	C2	C3	H	E1	E2	UNIT	INSERT	FIG.	WEIGHT (Kg)	
		Min.	Max.													
30	BT30-BCA13.5-105	13.5	16	105	68	12	13.0	44	15	5	0.2	M1B2E/F	BRAZED TYPE	1	-	
	BT30-BCA14.5-105	14.5	17	105	68	13	14.0	44	15	5	0.2	M1B2E/F	BRAZED TYPE	1	-	
	BT30-BCA16-105	16	22.5	105	73	14	15	-	18	-	0.2	M1A2E/F	BRAZED TYPE	3	-	
	BT30-BCA19-120	19	23	120	85	16	18	44	23	3	0.2	M2B2CC	CCGT0401	1	0.70	
	BT30-BCA23-135	23	29	135	105	19	22	-	24	-	0.2	M3B2TC	TBGT0601	3	0.70	
	BT30-BCA29-150	29	41	150	115	25	28	44	30	8	0.2	M3A2TC	TBGT0601	1	0.90	
	BT30-BCA29-195	29	41	195	115	25	28	44	30	53	0.2	M3A2TC	TBGT0601	1	-	
	BT30-BCA38-150	38	49	150	115	33	35	55	41	8	0.2	M5B2TC	TCGT1102	1	1.40	
	BT30-BCA38-210	38	49	210	175	33	37	55	41	8	0.2	M5B2TC	TCGT1102	1	-	
	BT30-BCA46-150	46	66	150	115	38	41	55	45	8	0.2	M5A2TC	TCGT1102	1	2.10	
	BT30-BCA46-210	46	66	210	175	38	45	55	45	8	0.2	M5A2TC	TCGT1102	1	-	
	BT30-BCA62-165	62	87	165	135	51	-	-	-	-	0.2	M7A2TC	TCGT16T3	2	-	
	40	BT40-BCA13.5-105	13.5	16	105	68	12	13.0	44	15	5	0.2	M1B2E/F	BRAZED TYPE	1	-
		BT40-BCA14.5-105	14.5	17	105	68	13	14.0	44	15	5	0.2	M1B2E/F	BRAZED TYPE	1	-
BT40-BCA16-105		16	22.5	105	73	14	15	-	18	-	0.2	M1A2E/F	BRAZED TYPE	3	-	
BT40-BCA19-120		19	23	120	85	16	18	44	23	3	0.2	M2B2CC	CCGT0401	1	1.50	
BT40-BCA23-135		23	29	135	105	19	22	-	24	-	0.2	M3B2TC	TBGT0601	3	1.50	
BT40-BCA29-150		29	41	150	115	25	28	44	30	8	0.2	M3A2TC	TBGT0601	1	1.50	
BT40-BCA29-195		29	41	195	115	25	28	44	30	53	0.2	M3A2TC	TBGT0601	1	2.00	
BT40-BCA38-150		38	49	150	115	33	35	55	41	8	0.2	M5B2TC	TCGT1102	1	1.80	
BT40-BCA38-210		38	49	210	175	33	37	55	41	8	0.2	M5B2TC	TCGT1102	1	2.20	
BT40-BCA46-150		46	66	150	115	38	41	55	45	8	0.2	M5A2TC	TCGT1102	1	2.10	
BT40-BCA46-210		46	66	210	175	38	45	55	45	8	0.2	M5A2TC	TCGT1102	1	2.30	
BT40-BCA62-165		62	87	165	135	51	-	-	-	-	0.2	M7A2TC	TCGT16T3	2	2.90	
BT40-BCA62-210		62	87	210	180	51	-	-	-	-	0.2	M7A2TC	TCGT16T3	2	3.60	
BT40-BCA83-150		83	108	150	120	63	-	-	-	-	0.2	M7A2TC	TCGT16T3	2	-	
BT40-BCA83-210	83	108	210	180	63	-	-	-	-	0.2	M7A2TC	TCGT16T3	2	-		
BT40-BCA98-150	98	142	150	120	83	-	-	85	-	0.2	M10A2TC	TCGT16T3	4	-		

▶ NEXT PAGE

MICRO BORING BAR

MIKRO - BOHRSTANGE
 BARRE D'ALÉSAGE MICRO
 PORTA TESTINE MICROREGISTRABILI
 BARRAS DE MANDRINAR MICRO

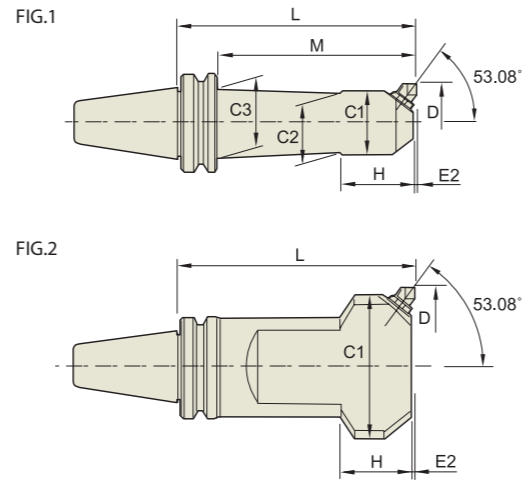

BT (JIS B6339/MAS 403)

Unit: mm

TAPER No.	MODEL No.	D (BORE RANGE)		L	M	C1	C2	C3	H	E1	E2	UNIT	INSERT	FIG.	WEIGHT (Kg)
		Min.	Max.												
50	BT50-BCA13.5-120	13.5	16	120	67	12	13	44	15	10	0.2	M1B2E/F	-	1	-
	BT50-BCA13.5-195	13.5	16	195	67	12	13	44	15	85	0.2	M1B2E/F	-	1	-
	BT50-BCA14.5-120	14.5	17	120	67	13	14	44	15	10	0.2	M1B2E/F	-	1	-
	BT50-BCA14.5-195	14.5	17	195	67	13	14	44	15	85	0.2	M1B2E/F	-	1	-
	BT50-BCA16-120	16	22.5	120	73	14	15	44	18	4	0.2	M1A2E/F	-	1	-
	BT50-BCA16-195	16	22.5	195	73	14	15	44	18	79	0.2	M1A2E/F	-	1	-
	BT50-BCA19-135	19	23	135	86	16	18	44	23	6	0.2	M2B2CC	CCGT0401	1	3.80
	BT50-BCA19-210	19	23	210	86	16	18	44	23	81	0.2	M2B2CC	CCGT0401	1	-
	BT50-BCA23-150	23	29	150	105	19	22	44	24	2	0.2	M3B2TC	TBGT0601	1	3.90
	BT50-BCA23-225	23	29	225	105	19	22	44	24	77	0.2	M3B2TC	TBGT0601	1	-
	BT50-BCA29-165	29	41	165	115	25	28	44	30	7	0.2	M3A2TC	TBGT0601	1	4.50
	BT50-BCA29-225	29	41	225	165	25	28	44	30	67	0.2	M3A2TC	TBGT0601	1	-
	BT50-BCA38-165	38	49	165	115	33	35	55	41	7	0.2	M5B2TC	TCGT1102	1	-
	BT50-BCA38-225	38	49	225	172	33	37	55	41	10	0.2	M5B2TC	TCGT1102	1	5.00
	BT50-BCA46-165	46	66	165	115	38	41	55	45	7	0.2	M5A2TC	TCGT1102	1	5.20
	BT50-BCA46-225	46	66	225	182	38	-	-	45	-	0.2	M5A2TC	TCGT1102	3	-
	BT50-BCA46-255	46	66	255	206	38	-	55	45	6	0.2	M5A2TC	TCGT1102	1	5.70
	BT50-BCA62-180	62	87	180	137	51	-	-	-	-	0.2	M7A2TC	TCGT16T3	2	7.00
	BT50-BCA62-240	62	87	240	184	51	57	70	60	13	0.2	M7A2TC	TCGT16T3	1	7.60
	BT50-BCA62-330	62	87	330	280	51	60	70	60	7	0.2	M7A2TC	TCGT16T3	1	9.50
	BT50-BCA83-165	83	108	165	122	63	-	-	-	-	0.2	M7A2TC	TCGT16T3	2	-
	BT50-BCA83-240	83	108	240	190	63	62	90	95	7	0.2	M7A2TC	TCGT16T3	1	-
	BT50-BCA83-345	83	108	345	295	63	62	90	95	7	0.2	M7A2TC	TCGT16T3	1	-
	BT50-BCA98-165	98	142	165	122	83	-	-	-	-	0.2	M10A2TC	TCGT16T3	2	-
	BT50-BCA98-240	98	142	240	197	83	-	-	-	-	0.2	M10A2TC	TCGT16T3	2	-
	BT50-BCA98-345	98	142	345	302	83	92	-	85	-	0.2	M10A2TC	TCGT16T3	3	-
	BT50-BCA132-210	132	176	210	-	108	-	-	65	-	0.2	M10A2TC	TCGT16T3	4	-
	BT50-BCA132-315	132	176	315	-	108	-	-	65	-	0.2	M10A2TC	TCGT16T3	4	-
	BT50-BCA166-225	166	210	225	-	142	-	-	70	-	0.2	M10A2TC	TCGT16T3	4	-
	BT50-BCA166-315	166	210	315	-	142	-	-	70	-	0.2	M10A2TC	TCGT16T3	4	-
	BT50-BCA200-210	200	244	210	-	176	-	-	75	-	0.2	M10A2TC	TCGT16T3	4	-

MICRO BORING BAR

MIKRO - BOHRSTANGE
 BARRE D'ALÉSAGE MICRO
 PORTA TESTINE MICROREGISTRABILI
 BARRAS DE MANDRINAR MICRO

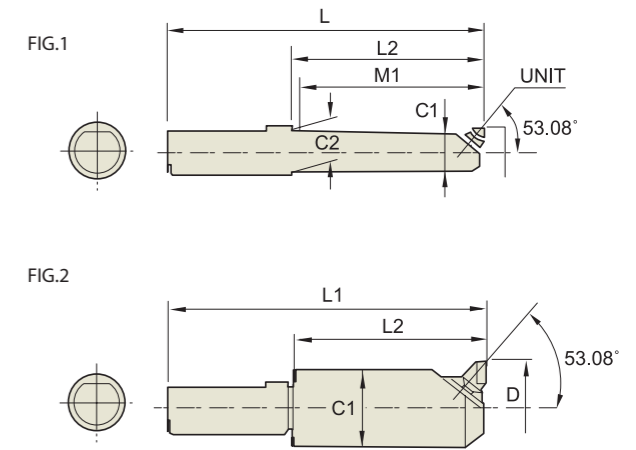

STRAIGHT-ST

Unit: mm

TAPER No.	MODEL No.	D (BORE RANGE)		L1	L2	M1	C1	C2	UNIT	FIG.	WEIGHT (Kg)
		Min.	Max.								
32	ST32-BCA13.5-75	13.5	16	135	75	67	12	13	M1B2E/F	1	0.50
	ST32-BCA14.5-75	14.5	17	145	75	67	12	14	M1B2E/F	1	0.50
	ST32-BCA16-90	16	22.5	160	90	82	14	15	M1A2E/F	1	0.50
	ST32-BCA19-90	19	23.0	160	90	82	16	18	M2B-2CC	1	0.50
	ST32-BCA23-120	23	29.0	190	120	110	19	22	M3B-2TC	1	1.00
	ST32-BCA29-120	29	41.0	190	120	110	25	28	M3A-2TC	1	1.00
	ST32-BCA38-120	38	49.0	190	120	115	33	35	M5B-2TC	2	1.50
	ST32-BCA46-120	46	66	190	120	115	38	-	M5A-2TC	2	1.50
	ST32-BCA62-120	62	87.0	190	120	115	51	-	M7A-2TC	2	2.50
	ST42-BCA13.5-85	13.5	16	165	85	67	12	13	M1B2E/F	1	1.00
ST42-BCA14.5-85	14.5	17	165	85	67	12	14	M1B2E/F	1	1.00	
ST42-BCA16-100	16	22.5	180	100	82	14	15	M1A2E/F	1	1.00	
ST42-BCA19-100	19	23.0	180	100	82	16	18	M2B2E/F	1	1.00	
ST42-BCA23-120	23	29.0	200	120	110	19	22	M3B-2TC	1	1.50	
ST42-BCA29-120	29	41.0	200	120	110	25	28	M3A-2TC	1	1.50	
ST42-BCA38-130	38	49.0	210	130	125	33	35	M5B-2TC	1	1.50	
ST42-BCA46-135	46	66.0	215	135	130	38	44	M5A-2TC	1	1.50	
ST42-BCA62-135	62	87.0	215	135	130	51	-	M7A-2TC	2	2.50	
ST42-BCA83-150	83	108	230	150	145	63	-	M7A-2TC	2	3.00	

BIG SIZE MICRO CUT BORING BAR

BT (JIS B6339/MAS 403)

BORING RING HOLDER

Unit : mm

MODEL No.	d	D	L
BT50-BRA140-105	140	197	105
BT50-BRA140-165	140	197	165
BT50-BRA191-105	191	248	105
BT50-BRA191-165	191	248	165
BT50-BRA242-105	242	299	105
BT50-BRA242-165	242	299	165
BT50-BRA293-105	293	350	105
BT50-BRA293-165	293	350	165
BT50-BRA344-105	344	401	105
BT50-BRA344-165	344	401	165
BT50-BRA395-105	395	452	105
BT50-BRA395-165	395	452	165

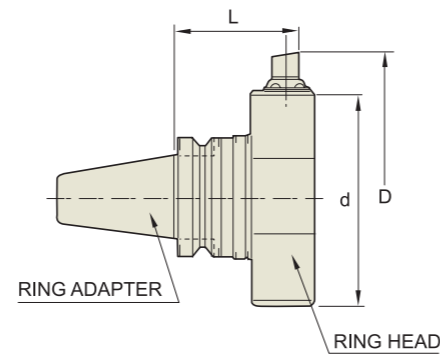

RING ADAPTOR

Unit : mm

MODEL No.	D (h6)	L	C1	C2
BT50-RAA32-60	32	60	102	82
BT50-RAA32-120	32	120	102	82

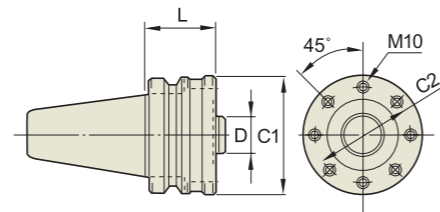

RING HEAD

Unit : mm

MODEL No.	D1 (h7)	D (BORE RANGE)		L	C1	C2	H	N	UNIT
		Min.	Max.						
RH32-BCA140	32	140	197	45	102	82	14	-	M10A2TC
RH32-BCA191	32	191	248	45	136	82	14	-	M10A2TC
RH32-BCA242	32	242	299	45	184	82	14	103	M10A2TC
RH32-BCA293	32	293	350	45	234	82	14	103	M10A2TC
RH32-BCA344	32	344	401	45	284	82	14	103	M10A2TC
RH32-BCA395	32	395	452	45	36	82	14	103	M10A2TC

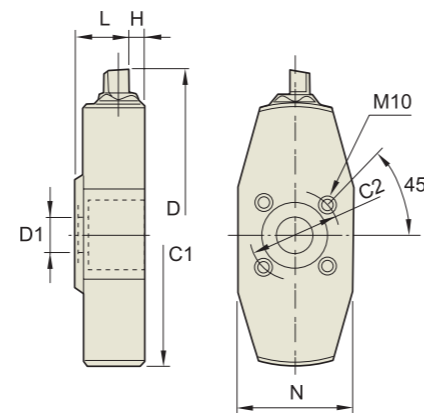

STRENGTH OF BORING BAR AND COMPARISON TABLE OF MICRO UNITS

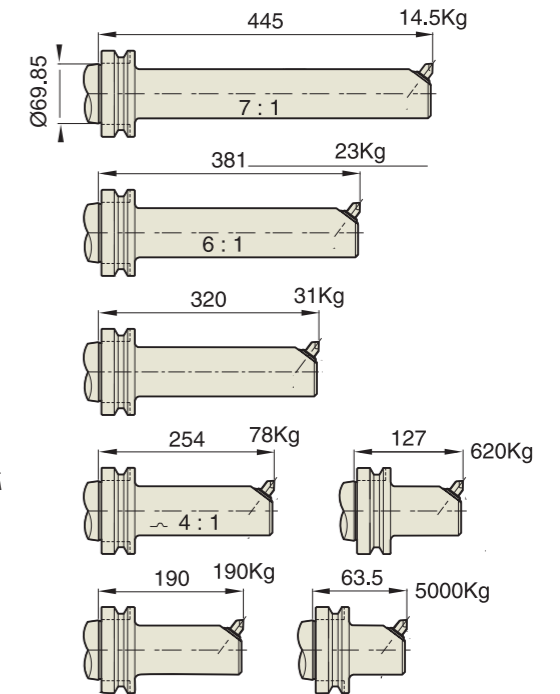
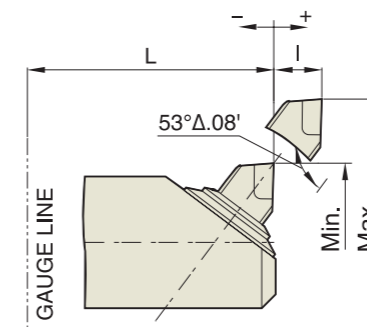

BORING BAR MODEL No.	BRAZED TYPE B EF		SCREW ON TYPE			INSERT SPEC.
	Min.	Max.	Min.	Max.	ΔL	
BCA19	M2B2	M2B2	-	-	-	CCGT0401
	19	23	-	-	-1.9	CCGT0401
BCA23	M3B2	M3B2	M3B2TC	M3B2TC	M3B2TC	TBGT060102
	23	29	24.9	30.9	-1.9	TBGT060102
BCA29	M3A2	M3A2	M3A2TC	M3A2TC	M3A2TC	TBGT060102
	29	41.8	30.9	43.8	-1.9	TBGT060102
BCA38	M5B2	M5B2	M5B2TC	M5B2TC	M5B2TC	TCGT110204
	38	49.2	40.9	52.1	-1.9	TCGT110204
BCA46	M5A2	M5A2	M5A2TC	M5A2TC	M5A2TC	TCGT110204
	46	66.6	48.9	69.5	-1.9	TCGT110204
BCA62	M7A2	M7A2	M7A2TC	M7A2TC	M7A2TC	TCGT16T304
	62	87.4	62	87.4	0	TCGT16T304
BCA83	M7A2	M7A2	M7A2TC	M7A2TC	M7A2TC	TCGT16T304
	83	108.4	83	108.4	0	TCGT16T304
BCA98	M10A2	M10A2	M10A2TC	M10A2TC	M10A2TC	TCGT16T304
	98	142.4	98	142.4	0	TCGT16T304
BCA132	M10A2	M10A2	M10A2TC	M10A2TC	M10A2TC	TCGT16T304
	132	176.4	132	176.4	0	TCGT16T304
BCA166	M10A2	M10A2	M10A2TC	M10A2TC	M10A2TC	TCGT16T304
	166	210.4	166	210.4	0	TCGT16T304
BCA200	M10A2	M10A2	M10A2TC	M10A2TC	M10A2TC	TCGT16T304
	200	244.4	200	244.4	0	TCGT16T304

MICRO UNIT SPARE PART

GRADUATED DIAL UNIT / LOCK SCREW AND WASHER

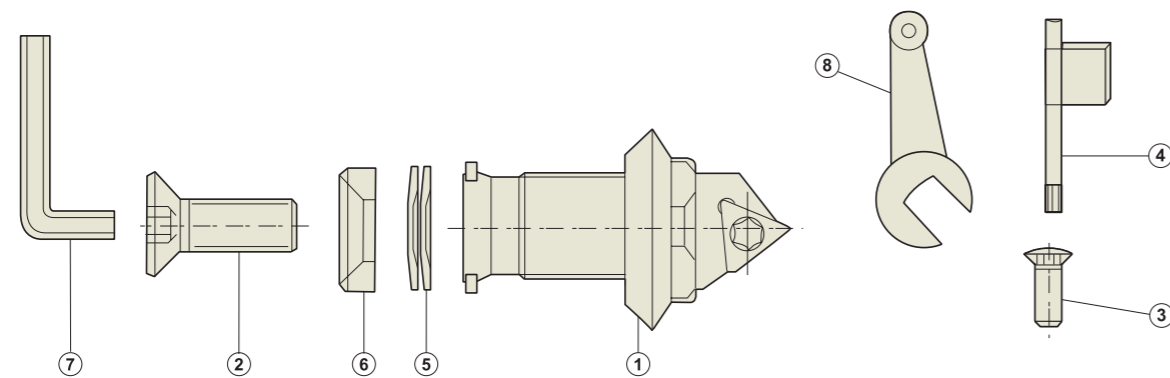

PART NAME		ORDER No.	M1A-B	M2A-B	M3A-B	M5A-B	M5A-B	M7A-B	M10A-B
1	DIAL NUT	Slant Angle	1-40	2-40	3-40	5-40	5-40	7-80	10-80
	DIAL NUT	Right Angle	1-50	2-50	3-50	5-50	5-50	7-100	10-100
2	CARTRIDGE BOLT	M-A	F-M3-0.5-8	F-M3-0.5-12	F-M4-0.7-15	F-M6-1.0-25	F-M6-1.0-25	F-M10-1.5-30	M12-1.75-50
	CARTRIDGE BOLT	M-B	M-M3-0.5-6	M-M3-0.5-10	M-M4-0.7-12	M-M6-1.0-20	M-M6-1.0-20	M-M10-1.5-25	M12-1.75-35
3	INSERT SCREW		S1845L5	S1845L5	S2045L6	S2555L6	S2555L6	S4095L6	S4095L6
4	T-WRENCH		T6	T6	T6	T8	T8	T15	T15
5	SPRING WASHER		-	CB-2	CB-3	CB-5	CB-5	CB-7	CB-10
6	MOUNTING WASHER		-	2306	3306	5306	5306	7306	10306
7	L-WRENCH		WR-2	WR-2	WR-2.5	WR-4	WR-4	WR-6	WR-8
8	SPANNER		GS12	GS12	GS35	GS35	GS35	GS710	GS710

MICRO UNIT SPARE PART

GRADUATED DIAL UNIT / LOCK SCREW AND WASHER

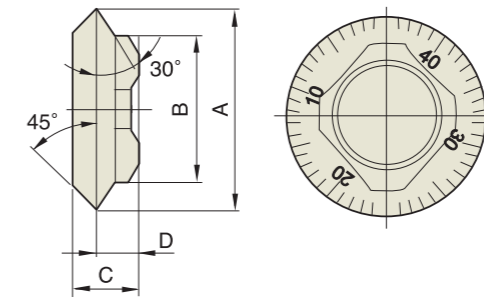

DIAL NUT

Unit : mm

SIZE	A	B	C	D
M1	9.53	6.99	4.45	2.54
M2	12.7	9.53	5.08	3.30
M3	15.88	11.3	5.59	3.56
M5	25.4	19.05	8.76	4.83
M7	34.93	25.40	11.68	7.11
M10	44.45	34.93	13.84	7.49

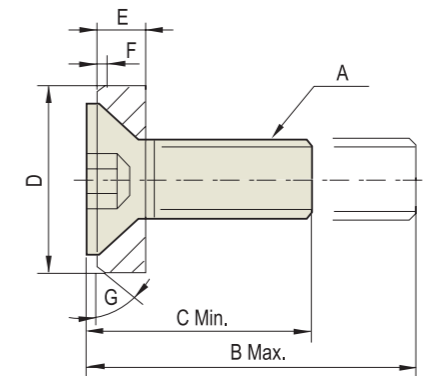

CARTIDGE BOLT

Unit : mm

SIZE	A	B	C	D	E	F	G
M1	M3	8	6	-	-	-	-
M2	M3	12	10	7.82	1.83	0.5	45°
M3	M4	15	12	10.9	2.46	1.0	45°
M5	M6	25	20	15.7	4.32	0.8	37°
M7	M10	30	25	23.7	6.35	1.30	37°
M10	M12	50	35	31.6	7.92	2.5	37°

SQUARE BORING BAR (45°)

VIERKANT - BOHRSTANGE
 BARRE D'ALÉSAGE CARRÉ
 BARRA PORTA TESTINE
 BARRAS DE MANDRINAR CUADRADAS

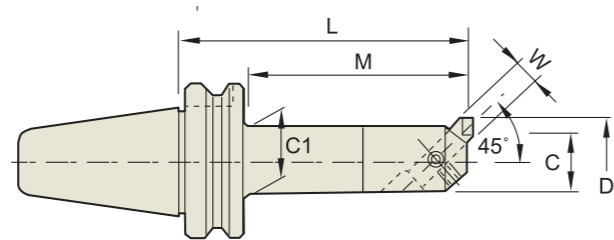

BT (JIS B6339/MAS 403)

Unit : mm

TAPER No.	MODEL No.	D (BORE RANGE)		L	C	C1	W	M	WEIGHT (Kg)
		Min.	Max.						
30	BT30-BSA25-120	25	38	120	20	22	8	90	1.00
	BT30-BSA30-135	30	42	135	24	26	8	105	1.10
	BT30-BSA38-150	38	52	150	30	33	10	120	1.40
	BT30-BSA42-150	42	56	150	34	37	10	125	1.60
	BT30-BSA50-150	50	65	150	40	44	13	125	1.80
40	BT40-BSA25-135	25	38	135	20	22	8	108	1.30
	BT40-BSA30-165	30	42	165	24	26	8	138	1.50
	BT40-BSA38-180	38	52	180	30	33	10	153	1.80
	BT40-BSA42-210	42	56	210	34	37	10	183	2.30
	BT40-BSA50-180	50	65	180	40	44	13	153	2.40
	BT40-BSA50-225	50	65	225	40	44	13	198	2.90
	BT40-BSA62-180	62	90	180	50	54	16	153	3.20
	BT40-BSA62-240	62	90	240	50	54	16	213	4.20
	BT40-BSA72-180	72	110	180	60	63	19	153	4.40
	BT40-BSA72-240	72	110	240	60	63	19	213	5.70
50	BT50-BSA90-180	90	125	180	75	63	19	153	5.40
	BT50-BSA25-135	25	38	135	20	22	8	95	4.40
	BT50-BSA30-165	30	42	165	24	26	8	125	4.60
	BT50-BSA38-180	38	52	180	30	33	10	140	4.80
	BT50-BSA42-210	42	56	210	34	37	10	170	5.00
	BT50-BSA50-180	50	65	180	40	44	13	140	5.40
	BT50-BSA50-240	50	65	240	40	44	13	200	5.70
	BT50-BSA62-195	62	90	195	50	54	16	155	6.10
	BT50-BSA62-270	62	90	270	50	54	16	230	7.50
	BT50-BSA72-195	72	110	195	60	66	19	155	6.90
	BT50-BSA72-285	72	110	285	60	66	19	245	9.30
	BT50-BSA90-210	90	125	210	75	80	19	170	9.20
	BT50-BSA90-300	90	125	300	75	80	19	260	12.30
	BT50-BSA105-195	105	160	195	90	90	25	157	10.50
	BT50-BSA105-285	105	160	285	90	90	25	247	14.80

SQUARE BORING BAR (90°)

VIERKANT - BOHRSTANGE
 BARRE D'ALÉSAGE CARRÉ
 BARRA PORTA TESTINE
 BARRAS DE MANDRINAR CUADRADAS

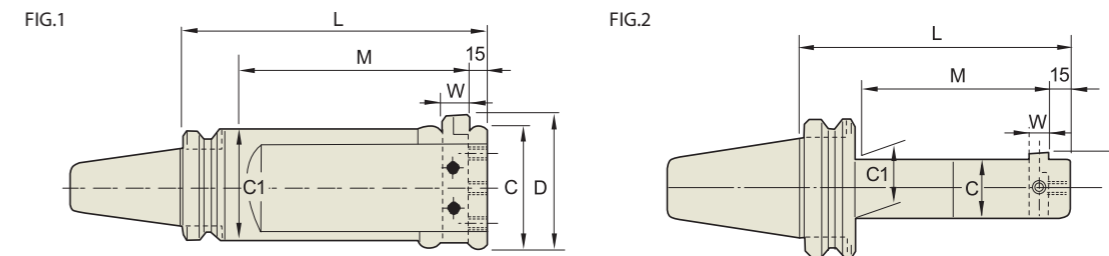

BT (JIS B6339/MAS 403)

Unit : mm

TAPER No.	MODEL No.	D (BORE RANGE)		L	C	C1	W	M	WEIGHT (Kg)	FIG.
		Min.	Max.							
30	BT30-BSB25-120	25	50	120	20	22	8	90	1.10	1
	BT30-BSB38-150	38	70	150	30	33	10	120	1.50	1
	BT30-BSB50-150	50	90	150	40	44	13	125	2.20	1
40	BT40-BSB25-135	25	50	135	20	22	8	108	1.30	1
	BT40-BSB38-180	38	70	180	30	33	10	153	1.90	1
	BT40-BSB50-180	50	90	180	40	44	13	153	2.60	1
	BT40-BSB50-225	50	90	225	40	44	13	198	3.10	1
	BT40-BSB62-180	62	115	180	50	56	16	153	3.40	1
	BT40-BSB62-225	62	115	225	50	56	16	198	4.10	1
	BT40-BSB72-180	72	135	180	60	66	19	153	4.70	1
	BT40-BSB72-225	72	135	225	60	66	19	198	5.60	1
	BT40-BSB90-180	90	150	180	75	80	19	153	5.70	1
	BT40-BSB90-225	90	150	225	75	80	19	198	6.60	1
50	BT50-BSB25-135	25	50	135	20	22	8	95	4.10	1
	BT50-BSB38-180	38	70	180	30	33	10	140	4.80	1
	BT50-BSB50-180	50	90	180	40	44	13	140	5.50	1
	BT50-BSB50-240	50	90	240	40	44	13	200	5.70	1
	BT50-BSB62-195	62	115	195	50	56	16	155	6.40	1
	BT50-BSB62-270	62	115	270	50	56	16	230	7.90	1
	BT50-BSB72-195	72	135	195	60	66	19	155	7.30	1
	BT50-BSB72-285	72	135	285	60	66	19	245	9.60	1
	BT50-BSB90-210	90	150	210	75	80	19	170	9.60	1
	BT50-BSB90-300	90	150	300	75	80	19	260	12.60	1
	BT50-BSB105-195	105	190	195	90	-	25	155	11.10	2
	BT50-BSB105-285	105	190	285	90	94	25	245	15.40	2

SQUARE BITE

SK (DIN 69871)

CBT (BT DUAL CONTACT)

BT (JIS B6339/MAS 403)

HSK (DIN 69893/ISO 12164)

STRAIGHT

ISO, NT, MTA/MTB, GOST

TOOL HOLDER SET

BORING SYSTEM

ACCESSORY & PARTS

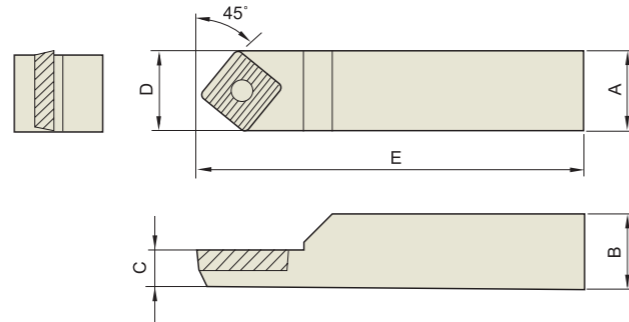

Unit : mm

SIZE	CLASSIFICATION							
	A	B	C	D	E	SCREW	WRENCH	INSERT
SBC08-45	8	8	6.3	8.39	70	SSB-2506	T7	CCMT0602
SBC10-45	10	10	7	10.39	70	SSB-2506	T7	CCMT0602
SBC13-45	13	13	10	13.6	80	SSB-4009	T15	CCMT09T3
SBC16-45	16	16	11	16.68	100	SSB-5012	T15	CCMT1204
SBC19-45	19	19	11	19.68	100	SSB-5012	T15	CCMT1204
SBC25-45	25	25	12.5	25.68	120	SSB-5012	T15	CCMT1204

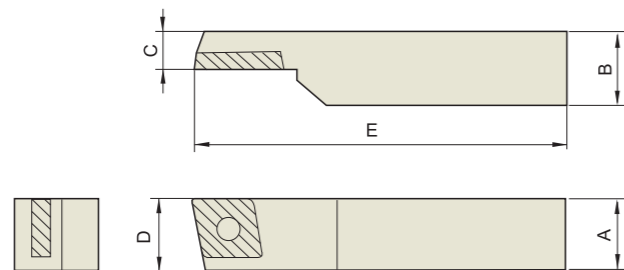

Unit : mm

SIZE	CLASSIFICATION							
	A	B	C	D	E	SCREW	WRENCH	INSERT
SBC10-90	10	10	7	10.4	70	SSB-2506	T7	CCMT0602
SBC13-90	13	13	10	13.6	80	SSB-4009	T15	CCMT09T3
SBC16-90	16	16	11	16.7	100	SSB-5012	T15	CCMT1204
SBC19-90	19	19	11	19.7	100	SSB-5012	T15	CCMT1204
SBC25-90	25	25	12.5	25.7	120	SSB-5012	T15	CCMT1204

YG-1 TOOLING SYSTEM

ACCESSORY & PARTS



HYDRAULIC CHUCK TEST PIECE



HYDRAULIC CHUCK COLLET



SHRINK FIT HEATING MACHINE

ER COLLET

TAP ER COLLET

ER NUT & SPANNER

SIDE LOCK BOLT FOR EMH

COLLAR BOLT & DRIVE KEY FOR SMA

DRIVE KEY & MOUNTING BOLT FOR FMA

MILLING CHUCK COLLET & SPANNER

SK COLLET, NUT, SPANNER

TAP ADAPTOR FOR TAPPING CHUCK

PULL STUD BOLT & SPANNER

TOOL CLAMP, HEIGHT PRESETTER

COOLANT TUBE & SPANNER FOR HSK

ADJUST BOLT MQL1 FOR HSK